

## 1. MANGUERAS Y CONEXIONES GATES

⊖ MANGUERAS	PAGS.	1 - 3
⊖ CONEXIONES G	PAGS.	4 - 19
⊖ CASQUILLOS GS	PAGS.	20
⊖ CONEXIONES GS	PAGS.	21 - 28

## 2. ADAPTADORES

⊖ BSP	PAGS.	29 - 39
⊖ JIC	PAGS.	40 - 49
⊖ DIN	PAGS.	50 - 56
⊖ ORFS	PAGS.	57 - 61

## 3. COMPONENTES HIDRÁULICOS

⊖ ENCHUFES RÁPIDOS	PAGS.	62 - 63
⊖ LLAVES DE PASO	PAGS.	64
⊖ ABRAZADERAS	PAGS.	65 - 66
⊖ MANÓMETROS Y TOMAS DE PRESIÓN	PAGS.	67 - 69
⊖ CILINDROS	PAGS.	70 - 71
⊖ VALVULERÍA	PAGS.	72 - 77
⊖ ACCESORIOS	PAGS.	78 - 82
⊖ BOMBAS MANUALES	PAGS.	83
⊖ DISTRIBUIDORES MANUALES	PAGS.	84

## 4. HIDRÁULICA

⊖ BOMBAS	PAGS.	85
⊖ MOTORES	PAGS.	86 - 87
⊖ DIRECCIONES	PAGS.	88
⊖ BOMBAS DE PISTONES AUTOASPIRANTES	PAGS.	89
⊖ INTERCAMBIADORES	PAGS.	90
⊖ ELECTROVÁLVULAS	PAGS.	91

## 5. OTROS PRODUCTOS Y SERVICIOS

⊖ MÁQUINAS DE PRENSAR	
⊖ GRUPOS HIDRÁULICOS	
⊖ NEUMÁTICA	
⊖ ESTANQUIDAD	
⊖ VENTA Y REPARACIÓN DE BOMBAS, MOTORES Y CILINDROS	
⊖ TUBERIA Y BARRA CROMADA	
⊖ FILTROS DE PRESIÓN	

# MANGUERA SERIE GATES



MANGUERA SAE 100 R1-AT				
REFERENCIA	MANGUERA	INT (mm.)	EXT (mm.)	BAR
BE704	1/4"	6	13,4	225
BE705	5/16"	8	15	215
BE706	3/8"	10	17,4	180
BE708	1/2"	12	20,6	160
BE710	5/8"	16	23,17	130
BE712	3/4"	19	27,7	105
BE716	1"	25	35,6	88
BE720	1 1/4"	31	43,5	63
BE724	1 1/2"	38	50,6	50
BE732	2"	51	64	40



MANGUERA SAE 100 R2-AT				
REFERENCIA	MANGUERA	INT (mm.)	EXT (mm.)	BAR
BJ404	1/4"	6	15	400
BJ405	5/16"	8	16,6	350
BJ406	3/8"	10	19	330
BJ408	1/2"	12	22,2	275
BJ410	5/8"	16	25,4	250
BJ412	3/4"	19	29,3	215
BJ416	1"	25	38,1	165
BJ420	1 1/4"	31	48,3	125
BJ424	1 1/2"	38	54,6	90
BJ432	2"	51	67,3	80



MANGUERA POWERWASH 1PW				
REFERENCIA	MANGUERA	INT (mm.)	EXT (mm.)	BAR
1PW05 AZUL	5/16"	8	15	200
1PW06 AZUL	3/8"	10	17,4	200
1PW08 AZUL	1/2"	12	20,6	200



MANGUERA POWERWASH 2PW				
REFERENCIA	MANGUERA	INT (mm.)	EXT (mm.)	BAR
2PW05 AZUL	5/16"	8	15,6	400
2PW06 AZUL	3/8"	10	17,5	400
2PW06 GRIS	3/8"	12	17,5	400

## MANGUERA SERIE GATES



MANGUERA R15 420 bar.				
REFERENCIA	MANGUERA	INT (mm.)	EXT (mm.)	BAR
BC13-6EFG6K	3/8"	10	20,3	420
BC13-8EFG6K	1/2"	12	23,9	420
BC13-10EFG6K	5/8"	16	27,7	420
BC13-12EFG6K	3/4"	19	31,5	420
BC13-16EFG6K	1"	25	38,9	420
BC13-20EFG6K	1 1/4"	31	50	420



MANGUERA R13 350 bar.				
REFERENCIA	MANGUERA	INT (mm.)	EXT (mm.)	BAR
BC13-8EFG5K	1/2"	12	23,9	350
BC13-10EFG5K	5/8"	16	27,7	350
BC13-12EFG5K	3/4"	19	31,5	350
BC13-16EFG5K	1"	25	38,9	350
BC13-20EFG5K	1 1/4"	31	50	350
BC13-24EFG5K	1 1/2"	38	57,4	350
BC13-32EFG5K	2"	51	71,1	350



MANGUERA R12 280 bar.				
REFERENCIA	MANGUERA	INT (mm.)	EXT (mm.)	BAR
BC13-12EFG4K	3/4"	19	30,7	280
BC13-16EFG4K	1"	25	38,1	280
BC13-20EFG4K	1 1/4"	31	47	280



MANGUERA R12 210 bar.				
REFERENCIA	MANGUERA	INT (mm.)	EXT (mm.)	BAR
BC13-20EFG3K	1 1/4"	31	47	210
BC13-24EFG3K	1 1/2"	38	53,6	210
BC13-32EFG3K	2"	51	66,8	210

## MANGUERA SERIE GATES



MANGUERA R7 TERMOPLASTICA				
REFERENCIA	MANGUERA	INT (mm.)	EXT (mm.)	BAR
HK 404	1/4	6	12,7	190
HK 405	5/16	8	14,8	170
HK 406	3/8	10	16,5	155
HK 408	1/2	12	21,1	140
HK 412	3/4	19	27,9	85
HK 416	1"	25	36	70



MANGUERA R7 TERMOPLASTICA DOBLE				
REFERENCIA	MANGUERA	INT (mm.)	EXT (mm.)	BAR
HK 404+HK 404	1/4	6	12,9	190
HK 405+HK 405	5/16	8	14,8	170
HK 406+HK 406	3/8	10	16,5	155
HK 408+HK 408	1/2	12	21,1	140

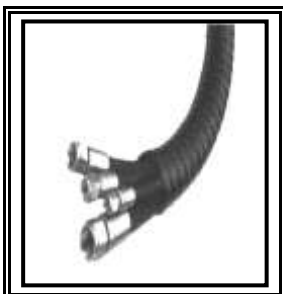

FUNDA PROTECTORA	
REFERENCIA	INT (mm.)
PROCTECPLAST 7	7,5
PROCTECPLAST 12	12,7
PROCTECPLAST 16	16
PROCTECPLAST 19	19
PROCTECPLAST 25	25,4
PROCTECPLAST 28	28
PROCTECPLAST 35	35

## CONEXIONES SERIE - G

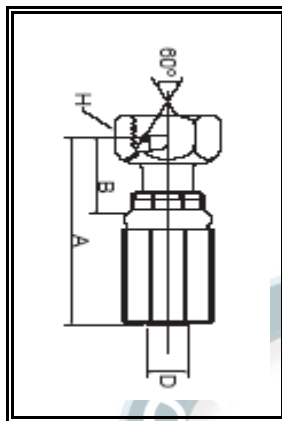

HEMBRA GIRATORIA BSP		
REFERENCIA	MANGUERA	ROSCA GAS
G 0402 NU - 04G02FBSPORX	1/4"	1/8"
G 0404 NU - 04G04FBSPORX	1/4"	1/4"
G 0406 NU - 04G06FBSPORX	1/4"	3/8"
G 0506 NU - 05G06FBSPORX	5/16"	3/8"
G 0606 NU - 06G06FBSPORX	3/8"	3/8"
G 0608 NU - 06G08FBSPORX	3/8"	1/2"
G 0806 NU - 08G06FBSPORX	1/2"	3/8"
G 0808 NU - 08G08FBSPORX	1/2"	1/2"
G 0810 NU - 08G10FBSPORX	1/2"	5/8"
G 0812 NU - 08G12FBSPORX	1/2"	3/4"
G 1010 NU - 10G10FBSPORX	5/8"	5/8"
G 1012 NU - 10G12FBSPORX	5/8"	3/4"
G 1212 NU - 12G12FBSPORX	3/4"	3/4"
G 1216 NU - 12G16FBSPORX	3/4"	1"
G 1616 NU - 16G16FBSPORX	1"	1"
G 2020 NU - 20G20FBSPORX	1 1/4"	1 1/4"

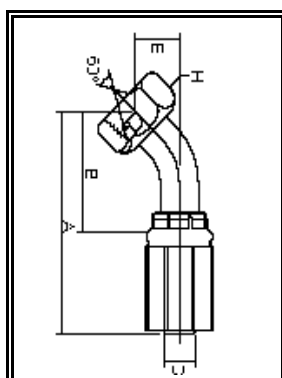

HEMBRA GIRATORIA BSP 45°		
REFERENCIA	MANGUERA	ROSCA GAS
G 0404 NU 45 - 04G04FBSPORX45	1/4"	1/4"
G 0406 NU 45 - 04G06FBSPORX45	1/4"	3/8"
G 0506 NU 45 - 05G06FBSPORX45	5/16"	3/8"
G 0606 NU 45 - 06G06FBSPORX45	3/8"	3/8"
G 0608 NU 45 - 06G08FBSPORX45	3/8"	1/2"
G 0808 NU 45 - 08G08FBSPORX45	1/2"	1/2"
G 0810 NU 45 - 08G10FBSPORX45	1/2"	5/8"
G 1010 NU 45 - 10G10FBSPORX45	5/8"	5/8"
G 1012 NU 45 - 10G12FBSPORX45	5/8"	3/4"
G 1212 NU 45 - 12G12FBSPORX45	3/4"	3/4"
G 1616 NU 45 - 16G16FBSPORX45	1"	1"
G 2020 NU 45 - 20G20FBSPORX45	1 1/4"	1 1/4"

## CONEXIONES SERIE - G

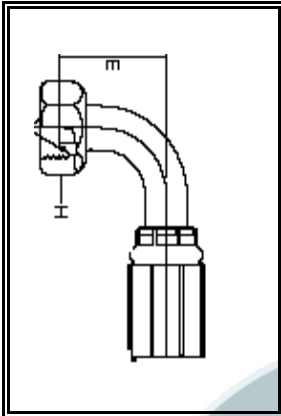

HEMBRA GIRATORIA BSP 90°		
REFERENCIA	MANGUERA	ROSCA GAS
G 0404 NU 90 - 04G04FBSPORX90	1/4"	1/4"
G 0406 NU 90 - 04G06FBSPORX90	1/4"	3/8"
G 0506 NU 90 - 05G06FBSPORX90	5/16"	3/8"
G 0606 NU 90 - 06G06FBSPORX90	3/8"	3/8"
G 0608 NU 90 - 06G08FBSPORX90	3/8"	1/2"
G 0808 NU 90 - 08G08FBSPORX90	1/2"	1/2"
G 0810 NU 90 - 08G10FBSPORX90	1/2"	5/8"
G 1010 NU 90 - 10G10FBSPORX90	5/8"	5/8"
G 1012 NU 90 - 10G12FBSPORX90	5/8"	3/4"
G 1212 NU 90 - 12G12FBSPORX90	3/4"	3/4"
G 1616 NU 90 - 16G16FBSPORX90	1"	1"
G 2020 NU 90 - 20G20FBSPORX90	1 1/4"	1 1/4"

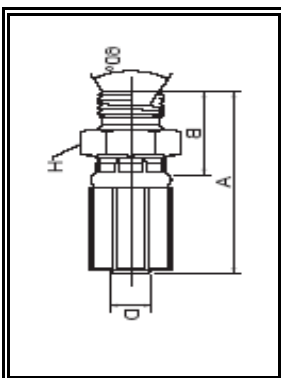

MACHO BSP		
REFERENCIA	MANGUERA	ROSCA GAS
G 0404 MU - 04G04MBSPP	1/4"	1/4"
G 0406 MU - 04G06MBSPP	1/4"	3/8"
G 0506 MU - 05G06MBSPP	5/16"	3/8"
G 0606 MU - 06G06MBSPP	3/8"	3/8"
G 0608 MU - 06G08MBSPP	3/8"	1/2"
G 0808 MU - 08G08MBSPP	1/2"	1/2"
G 0810 MU - 08G10MBSPP	1/2"	5/8"
G 1010 MU - 10G10MBSPP	5/8"	5/8"
G 1012 MU - 10G12MBSPP	5/8"	3/4"
G 1212 MU - 12G12MBSPP	3/4"	3/4"
G 1616 MU - 16G16MBSPP	1"	1"
G 2020 MU - 20G20MBSPP	1 1/4"	1 1/4"

## CONEXIONES SERIE - G

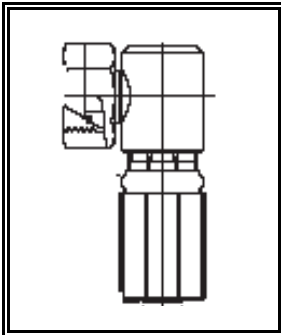

HEMBRA GIRATORIA BSP 90° CODO CORTO		
REFERENCIA	MANGUERA	ROSCA GAS
G 0404 NU 90S - 04G04FBSPORX90BL	1/4"	1/4"
G 0406 NU 90S - 04G06FBSPORX90BL	1/4"	3/8"
G 0606 NU 90S - 06G06FBSPORX90BL	3/8"	3/8"
G 0608 NU 90S - 06G08FBSPORX90BL	3/8"	1/2"
G 0808 NU 90S - 08G08FBSPORX90BL	1/2"	1/2"
G 0810 NU 90S - 08G10FBSPORX90BL	1/2"	5/8"
G 1010 NU 90S - 10G10FBSPORX90BL	5/8"	5/8"
G 1212 NU 90S - 12G12FBSPORX90BL	3/4"	3/4"
G 1616 NU 90S - 16G16FBSPORX90BL	1"	1"

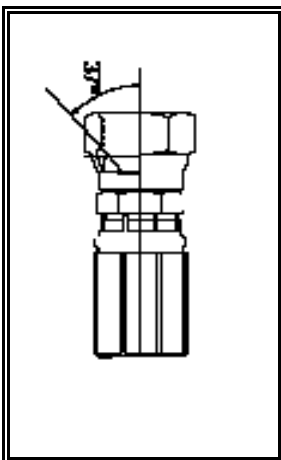

HEMBRA GIRATORIA JIC		
REFERENCIA	MANGUERA	ROSCA JIC
G 0404 NJ - 04G04FJX	1/4"	7/16"
G 0405 NJ - 04G05FJX	1/4"	1/2"
G 0406 NJ - 04G06FJX	1/4"	9/16"
G 0505 NJ - 05G05FJX	5/16"	1/2"
G 0506 NJ - 05G06FJX	5/16"	9/16"
G 0606 NJ - 06G06FJX	3/8"	9/16"
G 0608 NJ - 06G08FJX	3/8"	3/4"
G 0610 NJ - 06G10FJX	3/8"	7/8"
G 0806 NJ - 08G06FJX	1/2"	9/16"
G 0808 NJ - 08G08FJX	1/2"	3/4"
G 0810 NJ - 08G10FJX	1/2"	7/8"
G 0812 NJ - 08G12FJX	1/2"	1 1/16"
G 1010 NJ - 10G10FJX	5/8"	7/8"
G 1012 NJ - 10G12FJX	5/8"	1 1/16"
G 1212 NJ - 12G12FJX	3/4"	1 1/16"
G 1216 NJ - 12G16FJX	3/4"	1 5/16"
G 1616 NJ - 16G16FJX	1"	1 5/16"
G 2020 NJ - 20G20FJX	1 1/4"	1 5/8"



## CONEXIONES SERIE - G

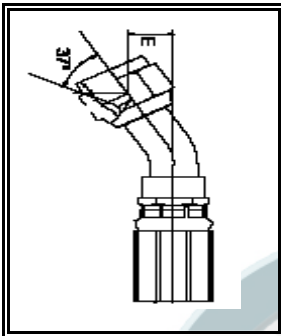

HEMBRA GIRATORIA JIC 45°		
REFERENCIA	MANGUERA	ROSCA JIC
G 0404 NJ 45 - 04G04FJX45	1/4"	7/16"
G 0405 NJ 45 - 04G05FJX45	1/4"	1/2"
G 0406 NJ 45 - 04G06FJX45	1/4"	9/16"
G 0505 NJ 45 - 05G05FJX45	5/16"	1/2"
G 0506 NJ 45 - 05G06FJX45	5/16"	9/16"
G 0606 NJ 45 - 06G06FJX45	3/8"	9/16"
G 0608 NJ 45 - 06G08FJX45	3/8"	3/4"
G 0808 NJ 45 - 08G08FJX45	1/2"	3/4"
G 0810 NJ 45 - 08G10FJX45	1/2"	7/8"
G 1010 NJ 45 - 10G10FJX45	5/8"	7/8"
G 1012 NJ 45 - 10G12FJX45	5/8"	1 1/16"
G 1212 NJ 45 - 12G12FJX45	3/4"	1 1/16"
G 1216 NJ 45 - 12G16FJX45	3/4"	1 5/16"
G 1616 NJ 45 - 16G16FJX45	1"	1 5/16"
G 2020 NJ 45 - 20G20FJX45	1 1/4"	1 5/8"

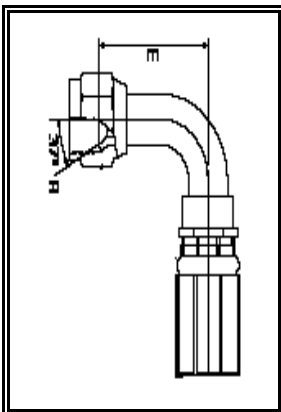

HEMBRA GIRATORIA JIC 45°		
REFERENCIA	MANGUERA	ROSCA JIC
G 0404 NJ 90 - 04G04FJX90	1/4"	7/16"
G 0405 NJ 90 - 04G05FJX90	1/4"	1/2"
G 0406 NJ 90 - 04G06FJX90	1/4"	9/16"
G 0505 NJ 90 - 05G05FJX90	5/16"	1/2"
G 0506 NJ 90 - 05G06FJX90	5/16"	9/16"
G 0606 NJ 90 - 06G06FJX90	3/8"	9/16"
G 0608 NJ 90 - 06G08FJX90	3/8"	3/4"
G 0808 NJ 90 - 08G08FJX90	1/2"	3/4"
G 0810 NJ 90 - 08G10FJX90	1/2"	7/8"
G 0812 NJ 90 - 08G12FJX90	1/2"	1 1/16"
G 1010 NJ 90 - 10G10FJX90	5/8"	7/8"
G 1012 NJ 90 - 10G12FJX90	5/8"	1 1/16"
G 1212 NJ 90 - 12G12FJX90	3/4"	1 1/16"
G 1616 NJ 90 - 16G16FJX 90	1"	1 5/16"
G 2020 NJ 90 - 20G20FJX 90	1 1/4"	1 5/8"

## CONEXIONES SERIE - G

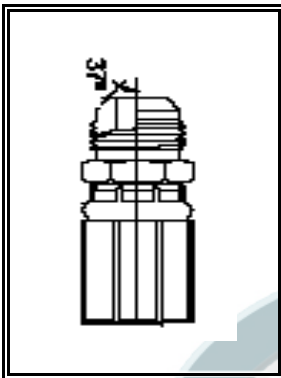

MACHO JIC		
REFERENCIA	MANGUERA	ROSCA JIC
G 0404 MJ	1/4"	7/16"
G 0405 MJ	1/4"	1/2"
G 0406 MJ	1/42	9/16"
G 0505 MJ	5/16"	1/2"
G 0506 MJ	5/16"	9/16"
G 0606 MJ	3/8"	9/16"
G 0608 MJ	3/8"	1/2"
G 0610 MJ	3/8"	7/8"
G 0808 MJ	1/2"	1/2"
G 0810 MJ	1/2"	7/8"
G 0812 MJ	1/2"	1 1/16"
G 1010 MJ	5/8"	7/8"
G 1012 MJ	5/8"	1 1/16"
G 1212 MJ	3/4"	1 1/16"
G 1616 MJ	1"	1 5/16"
G 2020 MJ	1 1/4"	1 5/8"

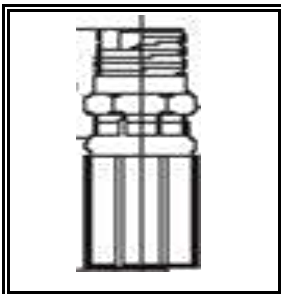

MACHO CONICO BSP		
REFERENCIA	MANGUERA	ROSCA GAS
G 0404 MT - 04G04MBSPT	1/4"	1/4"
G 0406 MT - 04G06MBSPT	1/4"	3/8"
G 0506 MT - 05G06MBSPT	5/16"	3/8"
G 0606 MT - 06G06MBSPT	3/8"	3/8"
G 0608 MT - 06G08MBSPT	3/8"	1/2"
G 0808 MT - 08G08MBSPT	1/2"	1/2"
G 1010 MT - 10G10MBSPT	5/8"	5/8"
G 1212 MT - 12G12MBSPT	3/4"	3/4"
G 1616 MT - 16G16MBSPT	1"	1"

## CONEXIONES SERIE - G

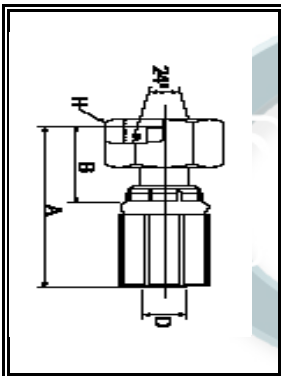

HEMBRA GIRATORIA METRICA		
REFERENCIA	MANGUERA	ROSCA MET
G 0406 RO 12A - 04G06FDLORX	1/4"	12X1.5
G 0408 RO 14A - 04G06FDHORX	1/4"	14X1.5
G 0408 RO 16A - 04G08FDLORX	1/4"	16X1.5
G 0410 RO 16A - 04G10FDLORX	1/4"	16X1.5
G 0410 RO 18A - 04G10FDHORX	1/4"	18X1.5
G 0412 RO 18A - 04G12FDLORX	1/4"	18X1.5
G 0510 RO 16A - 05G10FDLORX	5/16"	16X1,5
G 0510 RO 18A - 05G10FDHORX	5/16"	18X1,5
G 0512 RO 18A - 05G12FDLORX	5/16"	18X1.5
G 0512 RO 20A - 05G12FDHORX	5/16"	20X1,5
G 0610 RO 16A - 06G10FDLORX	3/8"	16X1,5
G 0610 RO 18A - 06G10FDHORX	3/8"	18X1,5
G 0612 RO 18A - 06G12FDLORX	3/8"	18X1,5
G 0612 RO 20A - 06G12FDHORX	3/8"	20X1.5
G 0614 RO 22A - 06G14FDHORX	3/8"	22X1.5
G 0615 RO 22A - 06G15FDLORX	3/8"	22X1,5
G 0815 RO 22A - 08G15FDLORX	1/2"	22X1,5
G 0816 RO 24A - 08G16FDHORX	1/2"	24X1.5
G 0818 RO 26A - 08G18FDLORX	1/2"	24X1,5
G 1018 RO 26A - 10G18FDLORX	5/8"	26X1,5
G 1020 RO 30B - 10G20FDHORX	5/8"	30X2
G 1222 RO 30B - 12G22FDLORX	3/4"	30X2
G 1225 RO 36B - 12G25FDLORX	3/4"	36X2
G 1625 RO 36B - 16G25FDHORX	1"	36X2
G 1628 RO 36B - 16G28FDLORX	1"	36X2
G 1630 RO 42B - 16G30FDHORX	1"	42X2
G 2035 RO 45B - 20G35FDLORX	1 1/4"	45X2
G 2038 RO 52B - 20G38FDHORX	1 1/4"	52X2

## CONEXIONES SERIE - G

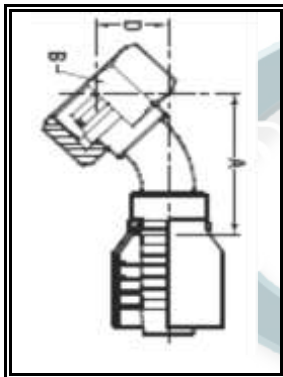

HEMBRA GIRATORIA METRICA 45ª		
REFERENCIA	MANGUERA	ROSCA MET
G 0406 RO 12A 45 - 04G06FDLORX 45	1/4"	12X1,5
G 0408 RO 14A 45 - 04G06FDHORX45	1/4"	14X1.5
G 0408 RO 16A 45 - 04G08FDLORX45	1/4"	16X1.5
G 0410 RO 16A 45 - 04G10FDLORX45	1/4"	16X1.5
G 0410 RO 18A 45 - 04G10FDHORX45	1/4"	18X1.5
G 0412 RO 18A 45 - 04G12FDLORX45	1/4"	18X1.5
G 0510 RO 16A 45 - 05G10FDLORX45	5/16"	16X1,5
G 0510 RO 18A 45 - 05G10FDHORX45	5/16"	18X1,5
G 0512 RO 18A 45 - 05G12FDLORX45	5/16"	18X1.5
G 0512 RO 20A 45 - 05G12FDHORX45	5/16"	20X1,5
G 0610 RO 16A 45 - 06G10FDLORX45	3/8"	16X1,5
G 0610 RO 18A 45 - 06G10FDHORX45	3/8"	18X1,5
G 0612 RO 18A 45 - 06G12FDLORX45	3/8"	18X1,5
G 0612 RO 20A 45 - 06G12FDHORX45	3/8"	20X1,5
G 0614 RO 22A 45 - 06G14FDHORX45	3/8"	22X1,5
G 0615 RO 22A 45 - 06G15FDLORX45	3/8"	22X1,5
G 0815 RO 22A 45 - 08G15FDLORX45	1/2"	22X1,5
G 0816 RO 24A 45 - 08G16FDHORX45	1/2"	24X1,5
G 0818 RO 24A 45 - 08G18FDLORX45	1/2"	24X1,5
G 1018 RO 26A 45 - 10G18FDLORX45	5/8"	26X1,5
G 1020 RO 30B 45 - 10G20FDHORX45	5/8"	30X2
G 1222 RO 30B 45 - 12G22FDLORX45	3/4"	30X2
G 1225 RO 36B 45 - 12G25FDLORX45	3/4"	36X2
G 1625 RO 36B 45 - 12G25FDLORX45	1"	36X2
G 1628 RO 36B 45 - 16G28FDLORX45	1"	36X2
G 1630 RO 42B 45 - 16G30FDHORX45	1"	42X2
G 2035 RO 45B 45 - 20G35FDLORX45	1 1/4"	45X2
G 2038 RO 52B 45 - 20G38FDHORX45	1 1/4"	52X2

## CONEXIONES SERIE - G



HEMBRA GIRATORIA METRICA 90°		
REFERENCIA	MANGUERA	ROSCA MET
G 0406 RO 12A 90 - 04G06FDLORX90	1/4"	12X1,5
G 0408 RO 14A 90 - 04G06FDHORX90	1/4"	14X1.5
G 0408 RO 16A 90 - 04G08FDLORX90	1/4"	16X1.5
G 0410 RO 16A 90 - 04G10FDLORX90	1/4"	16X1.5
G 0410 RO 18A 90 - 04G10FDHORX90	1/4"	18X1.5
G 0412 RO 18A 90 - 04G12FDLORX90	1/4"	18X1.5
G 0510 RO 16A 90 - 05G10FDLORX90	5/16"	16X1,5
G 0510 RO 18A 90 - 05G10FDHORX90	5/16"	18X1,5
G 0512 RO 18A 90 - 05G12FDLORX90	5/16"	18X1.5
G 0512 RO 20A 90 - 05G12FDHORX90	5/16"	20X1,5
G 0610 RO 16A 90 - 06G10FDLORX90	3/8"	16X1,5
G 0610 RO 18A 90 - 06G10FDHORX90	3/8"	18X1,5
G 0612 RO 18A 90 - 06G12FDLORX90	3/8"	18X1,5
G 0612 RO 20A 90 - 06G12FDHORX90	3/8"	20X1.5
G 0614 RO 22A 90 - 06G14FDHORX90	3/8"	22X1.5
G 0615 RO 22A 90 - 06G15FDLORX90	3/8"	22X1,5
G 0815 RO 22A 90 - 08G15FDLORX90	1/2"	22X1,5
G 0816 RO 24A 90 - 08G16FDHORX90	1/2"	24X1.5
G 0818 RO 26A 90 - 08G18FDLORX90	1/2"	24X1,5
G 1018 RO 26A 90 - 10G18FDLORX90	5/8"	26X1,5
G 1020 RO 30B 90 - 10G20FDHORX90	5/8"	30X2
G 1222 RO 30B 90 - 12G22FDLORX90	3/4"	30X2
G 1225 RO 36B 90 - 12G25FDLORX90	3/4"	36X2
G 1625 RO 36B 90 - 12G25FDLORX90	1"	36X2
G 1628 RO 36B 90 - 16G28FDLORX90	1"	36X2
G 1630 RO 42B 90 - 16G30FDHORX90	1"	42X2
G 2035 RO 45B 90 - 20G35FDLORX90	1 1/4"	45X2
G 2038 RO 52B 90 - 20G38FDHORX90	1 1/4"	52X2

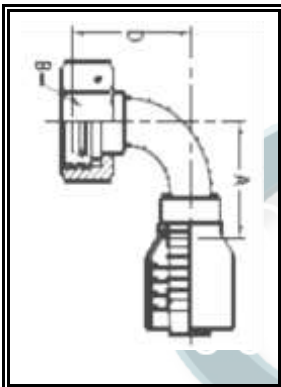

## CONEXIONES SERIE - G



MACHO METRICO		
REFERENCIA	MANGUERA	ROSCA MET
G 0406 MZ 12A - 04G06MDL	1/4"	12X1.5
G 0408 MZ 14A - 04G06MDL	1/4"	14X1.5
G 0408 MZ 16A - 04G08MDH	1/4"	16X1.5
G 0410 MZ 16A - 04G10MDL	1/4"	16X1.5
G 0410 MZ 18A - 04G10MDH	1/4"	18X1.5
G 0412 MZ 18A - 04G12MDL	1/4"	18X1.5
G 0510 MZ 16A - 05G10MDL	5/16"	16X1,5
G 0510 MZ 18A - 05G10MDH	5/16"	18X1,5
G 0512 RO 18A - 05G12MDL	5/16"	18X1.5
G 0512 MZ 20A - 05G12MDH	5/16"	20X1,5
G 0610 MZ 16A - 06G10MDL	3/8"	16X1,5
G 0610 MZ 18A - 06G10MDH	3/8"	18X1,5
G 0612 MZ 18A - 06G12MDL	3/8"	18X1,5
G 0612 MZ 20A - 06G12MDH	3/8"	20X1.5
G 0614 MZ 22A - 06G14MDH	3/8"	22X1.5
G 0615 MZ 22A - 06G15MDL	3/8"	22X1,5
G 0815 MZ 22A - 08G15MDL	1/2"	22X1,5
G 0816 MZ 24A - 08G16MDH	1/2"	24X1.5
G 0818 MZ 24A - 08G18MDL	1/2"	24X1,5
G 1018 MZ 26A - 10G18MDL	5/8"	26X1,5
G 1020 MZ 30B - 10G20MDH	5/8"	30X2
G 1222 MZ 30B - 12G22MDL	3/4"	30X2
G 1225 MZ 36B - 12G25MDH	3/4"	36X2
G 1625 MZ 36B - 16G25MDH	1"	36X2
G 1628 MZ 36B - 16G28MDL	1"	36X2
G 1630 MZ 42B - 16G30MDH	1"	42X2
G 2035 MZ 45B - 20G35MDL	1 1/4"	45X2
G 2038 MZ 52B - 20G38MDH	1 1/4"	52X2

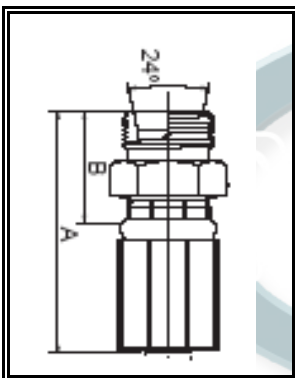

## CONEXIONES SERIE - G

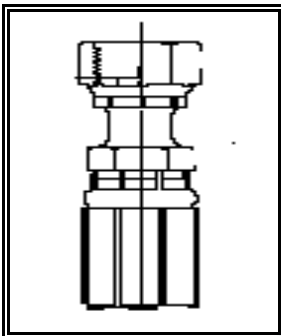

HEMBRA ASIENTO PLANO ORFS		
REFERENCIA	MANGUERA	ROSCA ORFS
G 0404 FF - 04G04FFORX	1/4"	9/16"
G 0406 FF - 04G06FFORX	1/4"	11/16"
G 0606 FF - 06G06FFORX	3/8"	11/16"
G 0608 FF - 06G08FFORX	3/8"	13/16"
G 0808 FF - 08G08FFORX	1/2"	13/16"
G 0810 FF - 08G10FFORX	1/2"	1"
G 1010 FF - 10G10FFORX	5/8"	1"
G 1012 FF - 10G12FFORX	5/8"	1 3/16"
G 1212 FF - 12G12FFORX	3/4"	1 3/16"
G 1216 FF - 12G16FFORX	3/4"	1 7/16"
G 1616 FF - 16G16FFORX	1"	1 7/16"
G 1620 FF - 16G20FFORX	1"	1 11/16"
G 2020 FF - 20G20FFORX	1 1/4"	1 11/16"

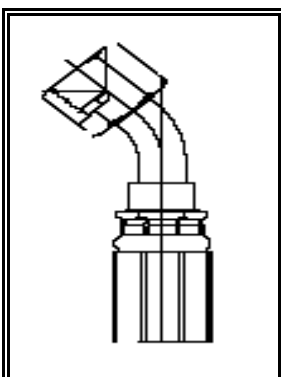

HEMBRA ASIENTO PLANO ORFS 45°		
REFERENCIA	MANGUERA	ROSCA ORFS
G 0404 FF 45 - 04G04FFORX45	1/4"	1/4"
G 0406 FF 45 - 04G06FFORX45	1/4"	3/8"
G 0506 FF 45 - 05G06FFORX45	5/16"	3/8"
G 0606 FF 45 - 06G06FFORX45	3/8"	3/8"
G 0608 FF 45 - 06G08FFORX45	3/8"	1/2"
G 0808 FF 45 - 08G08FFORX45	1/2"	1/2"
G 0810 FF 45 - 08G10FFORX45	1/2"	5/8"
G 1010 FF 45 - 10G10FFORX45	5/8"	5/8"
G 1012 FF 45 - 10G12FFORX45	5/8"	3/4"
G 1212 FF 45 - 12G12FFORX45	3/4"	3/4"
G 1616 FF 45 - 16G16FFORX45	1"	1"
G 2020 FF 45 - 20G20FFORX45	1 1/4"	1 1/4"

## CONEXIONES SERIE - G

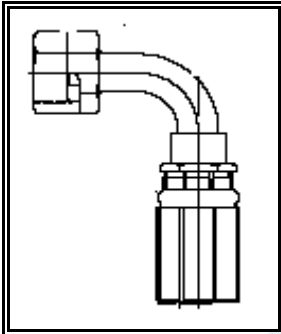

HEMBRA ASIENTO PLANO ORFS 90°		
REFERENCIA	MANGUERA	ROSCA ORFS
G 0404 FF 90 - 04G04FFORX90	1/4"	9/16"
G 0406 FF 90 - 04G06FFORX90	1/4"	11/16"
G 0506 FF 90 - 05G06FFORX90	5/16"	11/16"
G 0606 FF 90 - 06G06FFORX90	3/8"	11/16"
G 0608 FF 90 - 06G08FFORX90	3/8"	13/16"
G 0808 FF 90 - 08G08FFORX90	1/2"	13/16"
G 0810 FF 90 - 08G10FFORX90	1/2"	1"
G 1010 FF 90 - 10G10FFORX90	5/8"	1"
G 1012 FF 90 - 10G12FFORX90	5/8"	1 3/16"
G 1212 FF 90 - 12G12FFORX90	3/4"	1 3/16"
G 1216 FF 90 - 12G16FFORX80	3/4"	1 7/16"
G 1616 FF 90 - 16G16FFORX90	1"	1 7/16"
G 2020 FF 90 - 20G20FFORX90	1 1/4"	1 11/16"

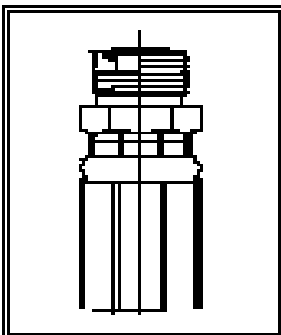

MACHO ASIENTO PLANO ORFS		
REFERENCIA	MANGUERA	ROSCA ORFS
G 0404 FMO - 04G04MFFOR	1/4"	1/4"
G 0406 FMO - 04G06MFFOR	1/4"	3/8"
G 0606 FMO - 06G06MFFOR	3/8"	3/8"
G 0608 FMO - 06G08MFFOR	3/8"	1/2"
G 0808 FMO - 08G08MFFOR	1/2"	1/2"
G 0810 FMO - 08G10MFFOR	1/2"	5/8"
G 1010 FMO - 10G10MFFOR	5/8"	5/8"
G 1012 FMO - 10G12MFFOR	5/8"	3/4"
G 1212 FMO - 12G12MFFOR	3/4"	3/4"
G 1616 FMO - 16G16MFFOR	1"	1"
G 2020 FMO - 20G20MFFOR	1 1/4"	1 1/4"



# CONEXIONES SERIE - G

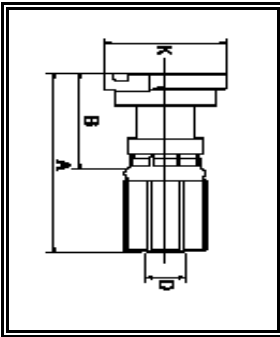

BRIDA SAE 3000 PSI		
REFERENCIA	MANGUERA	DIAM.
G 0808 PA - 08G08FL	1/2"	31,8
G 08012 PA - 08G12FL	1/2"	41,3
G 1212 PA - 12G12FL	3/4"	41,3
G 1216 PA - 12G16FL	3/4"	47,6
G 1616 PA - 16G16FL	1"	47,6
G 1620 PA - 16G20FL	1"	54
G 2020 PA - 20G20FL	1 1/4"	54

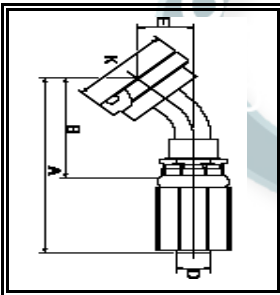

BRIDA SAE 3000 PSI 45°		
REFERENCIA	MANGUERA	DIAM.
G 0812 PA 45 - 08G12FL45	1/2"	41,3
G 1212 PA 45 - 12G12FL45	3/4"	41,3
G 1216 PA 45 - 12G16FL45	3/4"	47,6
G 1616 PA 45 - 12G16FL45	1"	47,6
G 1620 PA 45 - 16G20FL45	1"	54
G 2020 PA 45 - 20G20FL45	1 1/4"	54

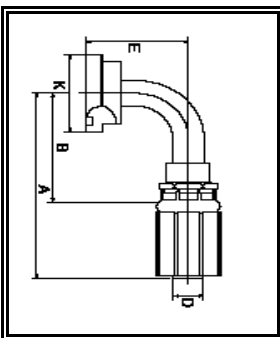

BRIDA SAE 3000 PSI 90°		
REFERENCIA	MANGUERA	DIAM.
G 0808 PA 90 - 08G08FL89	1/2"	31,8
G 0812 PA 90 - 08G12FL90	1/2"	41,3
G 1212 PA 90 - 12G12FL90	3/4"	41,3
G 1216 PA 90 - 12G16FL90	3/4"	47,6
G 1616 PA 90 - 16G16FL90	1"	47,6
G 1620 PA 90 - 16G20FL90	1"	54
G 2020 PA 90 - 20G20FL90	1 1/4"	54

## CONEXIONES SERIE - G

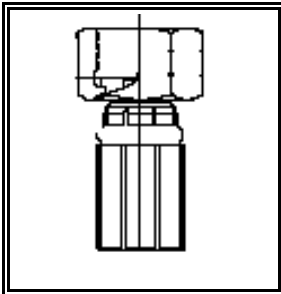

HEMBRA BSP ASIENTO PLANO		
REFERENCIA	MANGUERA	ROSCA GAS
G 0508 NUHB - 05G08FBFFX	5/16"	1/2"
G 0608 NUHB - 06G08FBFFX	3/8"	1/2"
G 0808 NUHB - 08G08FBFFX	1/2"	1/2"
G 0810 NUHB - 08G10FBFFX	1/2"	5/8"
G 0812 NUHB - 08G12FBFFX	1/2"	3/4"
G 1012 NUHB - 10G12FBFFX	5/8"	3/4"
G 1212 NUHB - 12G12FBFFX	3/4"	3/4"

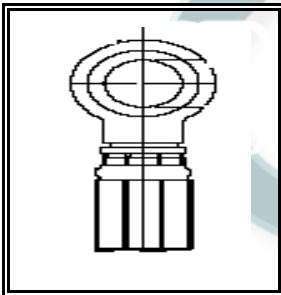

ESFERICO BSP		
REFERENCIA	MANGUERA	ROSCA GAS
G 0404 MURN - 04G04BSPBJ	1/4"	1/4"
G 0406 MURN - 04G06BSPBJ	1/4"	3/8"
G 0604 MURN - 06G04BSPBJ	3/8"	1/4"
G 0606 MURN - 06G06BSPBJ	3/8"	3/8"
G 0608 MURN - 06G08BSPBJ	3/8"	1/2"
G 0808 MURN - 08G08BSPBJ	1/2"	1/2"

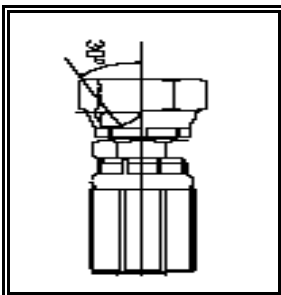

HEMBRA JAPONESA BSP		
REFERENCIA	MANGUERA	ROSCA GAS
G 0404 NP - 04G04FJISX	1/4"	1/4"
G 0606 NP - 06G06FJISX	3/8"	3/8"
G 0808 NP - 08G08FJISX	1/2"	1/2"
G 1212 NP - 12G12FJISX	3/4"	3/4"
G 1616 NP - 16G16FJISX	1"	1"

## CONEXIONES SERIE - G

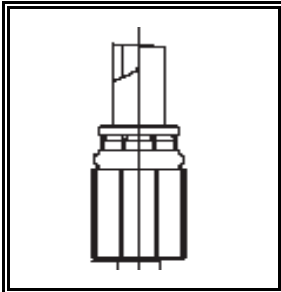

TUBULAR METRICO		
REFERENCIA	MANGUERA	TUBULAR
G 0406 RZ - 04G06MSP	1/4"	6
G 0408 RZ - 04G08MSP	1/4"	8
G 0410 RZ - 04G10MSP	1/4"	10
G 0508 RZ - 05G08MSP	5/16"	8
G 0510 RZ - 05G10MSP	5/16"	10
G 0512 RZ - 05G12MSP	5/16"	12
G 0610 RZ - 06G10MSP	3/8"	10
G 0612 RZ - 06G12MSP	3/8"	12
G 0815 RZ - 08G15MSP	1/2"	15
G 1018 RZ - 10G18MSP	5/8"	18

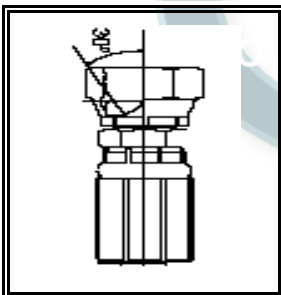

HEMBRA KOMATSU METRICA		
REFERENCIA	MANGUERA	METRICA
G 0404 NM - 04G04FKX	1/4"	14X1,5
G 0606 NM - 06G06FKX	3/8"	16X1,5
G 0808 NM - 08G08FKX	1/2"	22X1,5
G 1010 NM - 10G10FKX	5/8"	24X1,5
G 1212 NM - 12G12FKX	3/4"	30X1,5
G 1616 NM - 16G16FKX	1"	33X1,5

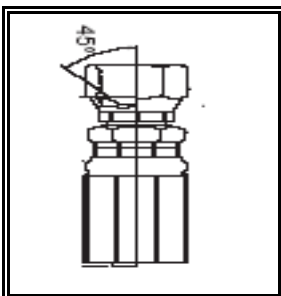

HEMBRA UNF		
REFERENCIA	MANGUERA	ROSCA UNF
G 0404 NS - 04G04FSX	1/4"	7/16"
G 0405 NS - 04G05FSX	1/4"	9/16"
G 0506 NS - 05G06FSX	5/16"	5/8"
G 0606 NS - 06G06FSX	3/8"	5/8"
G 0608 NS - 06G08FSX	3/8"	3/4"
G 0808 NS - 08G08FSX	1/2"	3/4"
G 0810 NS - 08G10FSX	1/2"	7/8"

# CONEXIONES SERIE - G

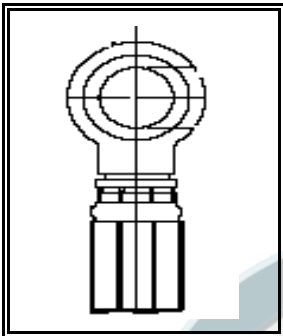

ESFERICO METRICO		
REFERENCIA	MANGUERA	ROSCA ORFS
G 0410 RN - 04G10BJ	1/4"	10
G 0412 RN - 04G12BJ	1/4"	12
G 0414 RN - 04G14BJ	1/4"	14
G 0416 RN - 04G16BJ	1/4"	16
G 0418 RN - 04G18BJ	1/4"	18
G 0512 RN - 05G12BJ	5/16"	12
G 0514 RN - 05G14BJ	5/16"	14
G 0516 RN - 05G16BJ	5/16"	16
G 0518 RN - 05G18BJ	5/16"	18
G 0614 RN - 06G14BJ	3/8"	14
G 0616 RN - 06G16BJ	3/8"	16
G 0618 RN - 06G18BJ	3/8"	18
G 0622 RN - 06G22BJ	3/8"	18
G 0818 RN - 08G18BJ	1/2"	18
G 0822 RN - 08G22BJ	1/2"	22
G 1022 RN - 10G22BJ	5/8"	22
G 1226 RN - 12G26BJ	3/4"	26

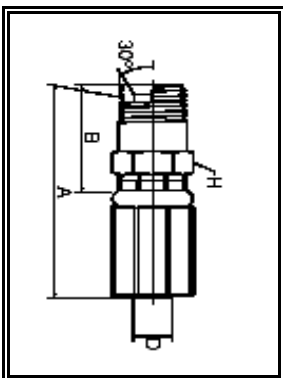

MACHO NPTF		
REFERENCIA	MANGUERA	ROSCA ORFS
G 0402 MB - 04G02MP	1/4"	1/8"
G 0404 MB - 04G04MP	1/4"	1/4"
G 0406 MB - 04G06MP	1/4"	3/8"
G 0504 MB - 05G04MP	5/16"	1/4"
G 0506 MB - 05G06MP	5/16"	3/8"
G 0604 MB - 06G04MP	3/8"	1/4"
G 0606 MB - 06G06MP	3/8"	3/8"
G 0608 MB - 06G08MP	3/8"	1/2"
G 0806 MB - 08G06MP	1/2"	3/8"
G 0808 MB - 08G08MP	1/2"	1/2"
G 1008 MB - 10G08MP	5/8"	1/2"
G 1212 MB - 12G12MP	3/4"	3/4"
G 1616 MB - 16G16MP	1"	1"

## CONEXIONES SERIE - G

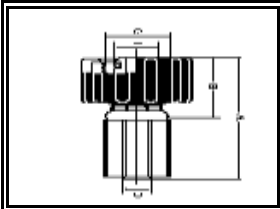

HEMBRA HIDROLAVADORA		
REFERENCIA	MANGUERA	METRICA
G 0415 KR 22A - 04G15FPWX	1/4"	22X1,5
G 0515 KR 22A - 05G15FPWX	5/16"	22X1,5
G 0615 KR 22A - 06G15FPWX	3/8"	22X1,5

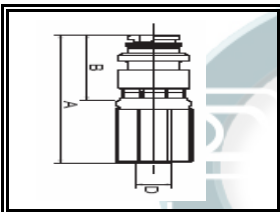

ESPIGA HIDROLAVADORA		
REFERENCIA	MANGUERA	TUBULAR
G 0410 KO - 04G10PWSP	1/4"	10
G 0510 KO - 05G10PWSP	5/16"	10
G 0610 KO - 06G10PWSP	3/8"	10



## CASQUILLOS SERIE GS

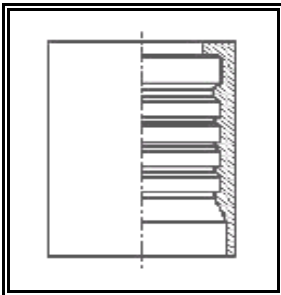

CASQUILLOS 4 Y 6 MALLAS	
REFERENCIA	MANGUERA
CPGS06 - 06GS 1F	3/8
CPGS08 - 08GS 1F	1/2
CPGS10 - 10GS 1F	5/8
CPGS12 - 12GS 1F	3/4
CPGS16 - 16GS 1F	1"
CPGS20/4 - 20GS 1F-4	1 1/4"
CPGS20/6 - 20GS 1F-6	1 1/4"
CPGS24 - 24GS 1F	1 1/2"
CPGS32 - 32PCM 2F CON PELADO	2"



## CONEXIONES SERIE - GS

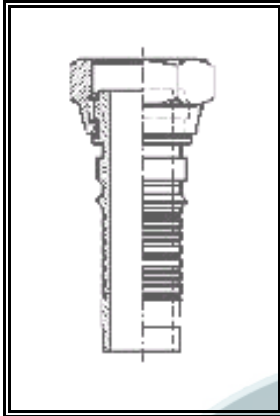

HEMBRA GIRATORIA BSP		
REFERENCIA	MANGUERA	ROSCA GAS
GS 0606 NU - 06GS06FBSPORX	3/8"	3/8"
GS 0608 NU - 06GS08FBSPORX	3/8"	1/2"
GS 0808 NU - 08GS08FBSPORX	1/2"	1/2"
GS 0810 NU - 08GS10FBSPORX	1/2"	5/8"
GS 1010 NU - 10GS10FBSPORX	5/8"	5/8"
GS 1012 NU - 10GS12FBSPORX	5/8"	3/4"
GS 1212 NU - 12GS12FBSPORX	3/4"	3/4"
GS 1216 NU - 12GS16FBSPORX	3/4"	1"
GS 1620 NU - 16GS20FBSPORX	1"	1 1/4"
GS 1616 NU - 16GS16FBSPORX	1"	1"
GS 2020 NU - 20GS20FBSPORX	1 1/4"	1 1/4"
GS 2424 NU - 24GS24FBSPORX	1 1/2"	1 1/2"
GS 3232 NU - 32GS32FBSPORX	2"	2"

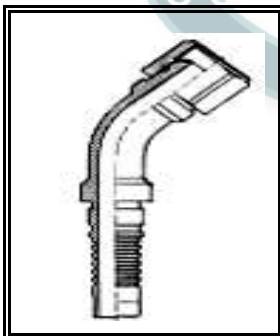

HEMBRA GIRATORIA BSP 45°		
REFERENCIA	MANGUERA	ROSCA GAS
GS 0606 NU 45 - 06G06FBSPORX45	3/8"	3/8"
GS 0808 NU 45 - 08G08FBSPORX45	1/2"	1/2"
GS 1010 NU 45 - 10G10FBSPORX45	5/8"	5/8"
GS 1012 NU 45 - 10G12FBSPORX45	5/8"	3/4"
GS 1212 NU 45 - 12G12FBSPORX45	3/4"	3/4"
GS 1616 NU 45 - 16G16FBSPORX45	1"	1"
GS 2020 NU 45 - 20G20FBSPORX45	1 1/4"	1 1/4"
GS 2424 NU 45 - 24G24FBSPORX45	1 1/2"	1 1/2"

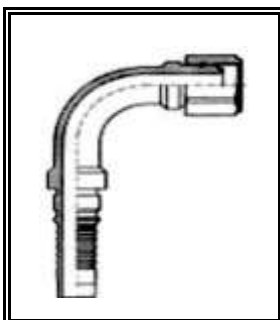

HEMBRA GIRATORIA BSP 90°		
REFERENCIA	MANGUERA	ROSCA GAS
GS 0606 NU 90 - 06GS06FBSPORX90	3/8"	3/8"
GS 0808 NU 90 - 08GS08FBSPORX90	1/2"	1/2"
GS 1010 NU 90 - 10GS10FBSPORX90	5/8"	5/8"
GS 1012 NU 90 - 10GS12FBSPORX90	5/8"	3/4"
GS 1212 NU 90 - 12GS12FBSPORX90	3/4"	3/4"
GS 1616 NU 90 - 16GS16FBSPORX90	1"	1"
GS 2020 NU 90 - 20GS20FBSPORX90	1 1/4"	1 1/4"
GS 2424 NU 90 - 24GS24FBSPORX90	1 1/2"	1 1/2"

## CONEXIONES SERIE - GS

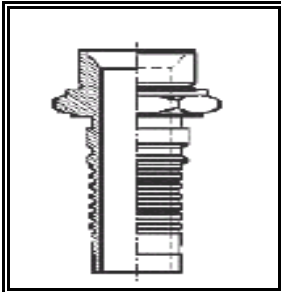

MACHO BSP		
REFERENCIA	MANGUERA	ROSCA GAS
GS 0606 MU - 06GS06MBSPP	3/8"	3/8"
GS 0608 MU - 06GS08MBSPP	3/8"	1/2"
GS 0808 MU - 08GS08MBSPP	1/2"	1/2"
GS 1010 MU - 10GS10MBSPP	5/8"	5/8"
GS 1212 MU - 12GS12MBSPP	3/4"	3/4"
GS 1616 MU - 16GS16MBSPP	1"	1"
GS 2020 MU - 20GS20MBSPP	1 1/4"	1 1/4"
GS 2424 MU - 24GS24MBSPP	1 1/2"	1 1/2"

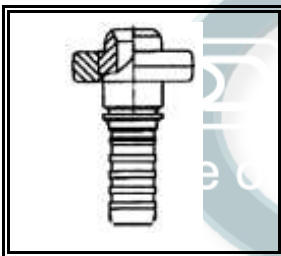

BRIDA MACHO POCLAIN		
REFERENCIA	MANGUERA	CONO
GS 0817 RYPPH - 04GS17MPFL	1/2"	17
GS 1021 RYPPH - 10GS21MPFL	5/8"	21
GS 1227 RYPPH - 12GS27MPFL	3/4"	27
GS 1634 RYPPH - 16GS34MPFL	1"	34

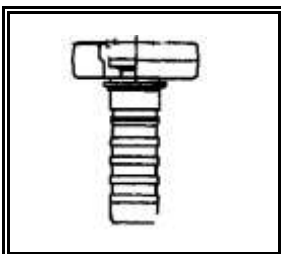

BRIDA HEMBRA POCLAIN		
REFERENCIA	MANGUERA	CONO
GS 0817 MGPPH - 08GS17FPFL	1/2"	17
GS 1021 MGPPH - 10GS21FPFL	5/8"	21
GS 1227 MGPPH - 12GS27FPFL	3/4"	27
GS 1634 MGPPH - 16GS34FPFL	1"	34

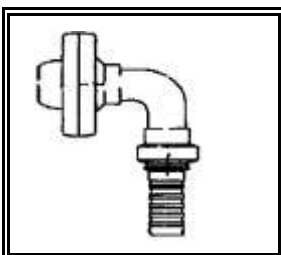

BRIDA MACHO 90° POCLAIN		
REFERENCIA	MANGUERA	CONO
GS 1021 RYPPH 90 - 10GS21MPFL90	5/8"	21
GS 1227 RYPPH 90 - 12GS27MPFL90	3/4"	27
GS 1634 RYPPH 90 - 16GS34MPFL90	1"	34



## CONEXIONES SERIE - GS

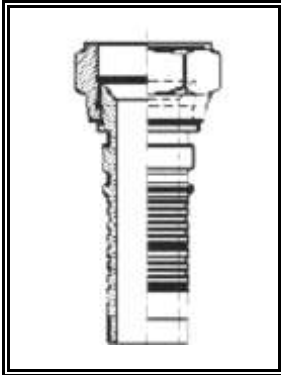

HEMBRA GIRATORIA JIC		
REFERENCIA	MANGUERA	ROSCA JIC
GS 0606 NJ - 06GS06FJX	3/8"	9/16"
GS 0608 NJ - 06GS08FJX	3/8"	3/4"
GS 0808 NJ - 08GS08FJX	1/2"	3/4"
GS 0810 NJ - 08GS10FJX	1/2"	7/8"
GS 0812 NJ - 08GS12FJX	1/2"	1 1/16"
GS 1010 NJ - 10GS10FJX	5/8"	7/8"
GS 1012 NJ - 10GS12FJX	5/8"	1 1/16"
GS 1212 NJ - 12GS12FJX	3/4"	1 1/16"
GS 1216 NJ - 12GS16FJX	3/4"	1 5/16"
GS 1616 NJ - 16GS16FJX	1"	1 5/16"
GS 2020 NJ - 20GS20FJX	1 1/4"	1 5/8"
GS 2424 NJ - 24GS24FJX	1 1/2"	1 7/8"

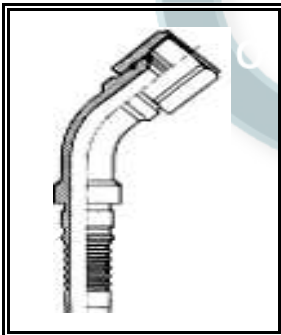

HEMBRA GIRATORIA JIC 45°		
REFERENCIA	MANGUERA	ROSCA JIC
GS 0606 NJ 45 - 06GS06FJX45	3/8"	9/16"
GS 0608 NJ 45 - 06GS08FJX45	3/8"	3/4"
GS 0808 NJ 45 - 08GS08FJX45	1/2"	3/4"
GS 0810 NJ 45 - 08GS10FJX45	1/2"	7/8"
GS 1010 NJ 45 - 10GS10FJX45	5/8"	7/8"
GS 1212 NJ 45 - 12G 12FJX45	3/4"	1 1/16"
GS 1216 NJ 45 - 12GS16FJX45	3/4"	1 5/16"
GS 1616 NJ 45 - 16GS16FJX45	1"	1 5/16"
GS 2020 NJ 45 - 20GS20FJX45	1 1/4"	1 5/8"
GS 2424 NJ 45 - 24GS24FJX45	1 1/2"	1 7/8"

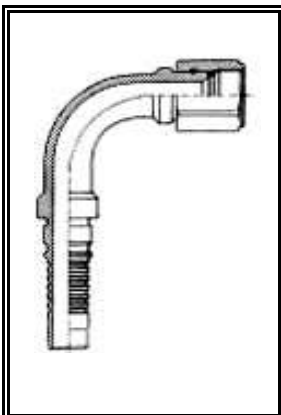

HEMBRA GIRATORIA JIC 45°		
REFERENCIA	MANGUERA	ROSCA JIC
GS 0606 NJ 90 - 06GS06FJX90	3/8"	9/16"
GS 0608 NJ 90 - 06GS08FJX90	3/8"	3/4"
GS 0808 NJ 90 - 08GS08FJX90	1/2"	3/4"
GS 0810 NJ 90 - 08GS10FJX90	1/2"	7/8"
GS 1010 NJ 90 - 10GS10FJX90	5/8"	7/8"
GS 1012 NJ 90 - 10GS12FJX90	5/8"	1 1/16"
GS 1212 NJ 90 - 12GS12FJX90	3/4"	1 1/16"
GS 1216 NJ 90 - 12GS16FJX90	3/4"	1 5/16"
GS 1616 NJ 90 - 16GS16FJX 90	1"	1 5/16"
GS 2020 NJ 90 - 20GS20FJX 90	1 1/4"	1 5/8"
GS 2424 NJ 90 - 24GS24FJX 90	1 1/4"	1 7/8"

## CONEXIONES SERIE - GS

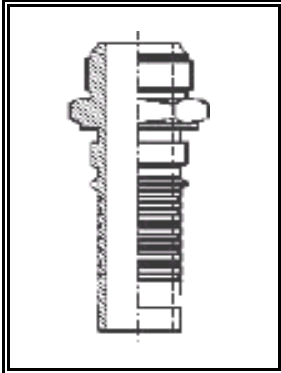

MACHO JIC		
REFERENCIA	MANGUERA	ROSCA JIC
GS 0606 MJ	3/8"	9/16"
GS 0608 MJ	3/8"	1/2"
GS 0808 MJ	1/2"	1/2"
GS 0810 MJ	1/2"	7/8"
GS 1010 MJ	5/8"	7/8"
GS 1012 MJ	5/8"	1 1/16"
GS 1212 MJ	3/4"	1 1/16"
GS 1216 MJ	3/4"	1 5/16"
GS 1616 MJ	1"	1 5/16"
GS 2020 MJ	1 1/4"	1 5/8"
GS 2424 MJ	1 1/2"	1 7/8"

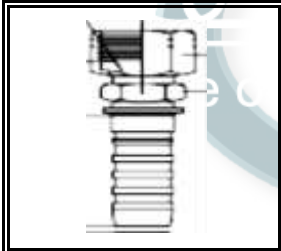

HEMBRA KOMATSU		
REFERENCIA	MANGUERA	METRICA
GS 0808 NM - 08GS08FKX	1/4"	22x1,5
GS 1010 NM - 10GS10FKX	1/4"	24x1,5
GS 1212 NM - 12GS12FKX	1/42	30x1,5

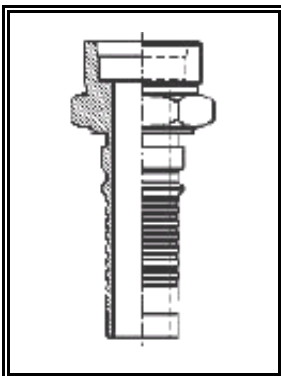

MACHO METRICO		
REFERENCIA	MANGUERA	ROSCA MET
GS 0612 MZ 18A - 06GS12MDL	3/8"	18X1,5
GS 0612 MZ 20A - 06GS12MDH	3/8"	20X1.5
GS 0614 MZ 22A - 06GS14MDH	3/8"	22X1.5
GS 0815 MZ 22A - 08GS15MDL	1/2"	22X1,5
GS 0816 MZ 24A - 08GS16MDH	1/2"	24X1.5
GS 1018 MZ 26A - 10GS18MDL	5/8"	26X1,5
GS 1020 MZ 30B - 10GS20MDH	5/8"	30X2
GS 1222 MZ 30B - 12GS22MDL	3/4"	30X2
GS 1225 MZ 36B - 12GS25MDH	3/4"	36X2
GS 1625 MZ 36B - 16GS25MDH	1"	36X2
GS 1628 MZ 36B - 16GS28MDL	1"	36X2
GS 1630 MZ 42B - 16GS30MDH	1"	42X2
GS 2038 MZ 52B - 20GS38MDH	1 1/4"	52X2

## CONEXIONES SERIE - GS

HEMBRA GIRATORIA METRICA		
REFERENCIA	MANGUERA	ROSCA MET
GS 0612 RO 18A - 06GS12FDLORX	3/8"	18X1,5
GS 0612 RO 20A - 06GS12FDHORX	3/8"	20X1.5
GS 0614 RO 22A - 06GS14FDHORX	3/8"	22X1.5
GS 0815 RO 22A - 08GS15FDLORX	1/2"	22X1,5
GS 0816 RO 24A - 08GS16FDHORX	1/2"	24X1.5
GS 1018 RO 26A - 10G 18FDLORX	5/8"	26X1,5
GS 1020 RO 30B - 10GS20FDHORX	5/8"	30X2
GS 1222 RO 30B - 12G22FDLORX	3/4"	30X2
GS 1225 RO 36B - 12GS25FDLORX	3/4"	36X2
GS 1625 RO 36B - 16GS25FDHORX	1"	36X2
GS 1628 RO 36B - 16GS28FDLORX	1"	36X2
GS 1630 RO 42B - 16GS30FDHORX	1"	42X2
GS 2035 RO 45B - 20GS35FDLORX	1 1/4"	45X2
GS 2038 RO 52B - 20GS38FDHORX	1 1/4"	52X2

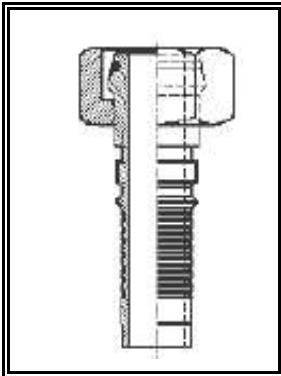

HEMBRA GIRATORIA METRICA 45°		
REFERENCIA	MANGUERA	ROSCA MET
GS 0612 RO 20A 45 - 06GS12FDHORX45	3/8"	20X1.5
GS 0614 RO 22A 45 - 06GS14FDHORX45	3/8"	22X1.5
GS 0815 RO 22A 45 - 08GS15FDLORX45	1/2"	22X1,5
GS 0816 RO 24A 45 - 08GS16FDHORX45	1/2"	24X1.5
GS 1020 RO 30B 45 - 10GS20FDHORX45	5/8"	30X2
GS 1222 RO 30B 45 - 12GS22FDLORX45	3/4"	30X2
GS 1225 RO 36B 45 - 12GS25FDLORX45	3/4"	36X2
GS 1625 RO 36B 45 - 12GS25FDLORX45	1"	36X2
GS 1628 RO 36B 45 - 16GS28FDLORX45	1"	36X2
GS 1630 RO 42B 45 - 16GS30FDHORX45	1"	42X2
GS 2038 RO 52B 45 - 20GS38FDHORX45	1 1/4"	52X2

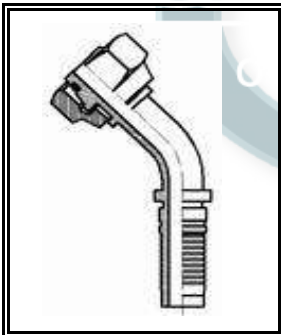

HEMBRA GIRATORIA METRICA 90°		
REFERENCIA	MANGUERA	ROSCA MET
GS 0612 RO 18A 90 - 06GS12FDLORX90	3/8"	18X1,5
GS 0612 RO 20A 90 - 06GS12FDHORX90	3/8"	20X1.5
GS 0614 RO 22A 90 - 06GS14FDHORX90	3/8"	22X1.5
GS 0815 RO 22A 90 - 08GS15FDLORX90	1/2"	22X1,5
GS 0816 RO 24A 90 - 08GS16FDHORX90	1/2"	24X1.5
GS 1018 RO 26A 90 - 10GS18FDLORX90	5/8"	26X1,5
GS 1020 RO 30B 20 - 10GS20FDHORX90	5/8"	30X2
GS 1222 RO 30B 90 - 12GS22FDLORX90	3/4"	30X2
GS 1225 RO 36B 90 - 12GS25FDLORX90	3/4"	36X2
GS 1625 RO 36B 90 - 12GS25FDLORX90	1"	36X2
GS 1628 RO 36B 90 - 16GS28FDLORX90	1"	36X2
GS 1630 RO 42B 90 - 16GS30FDHORX90	1"	42X2

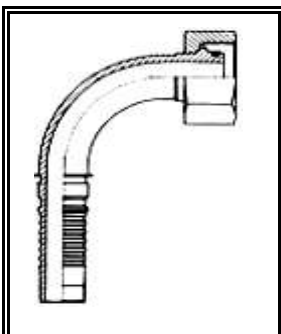

# CONEXIONES SERIE - GS

HEMBRA ASIENTO PLANO ORFS		
REFERENCIA	MANGUERA	ROSCA ORFS
GS 0606 FF - 06GS06FFORX	3/8"	11/16"
GS 0608 FF - 06GS08FFORX	3/8"	13/16"
GS 0808 FF - 08GS08FFORX	1/2"	13/16"
GS 0810 FF - 08GS10FFORX	1/2"	1"
GS 1010 FF - 10GS10FFORX	5/8"	1"
GS 1012 FF - 10GS12FFORX	5/8"	1 3/16"
GS 1212 FF - 12GS12FFORX	3/4"	1 3/16"
GS 1216 FF - 12GS16FFORX	3/4"	1 7/16"
GS 1616 FF - 16GS16FFORX	1"	1 7/16"
GS 1620 FF - 16GS20FFORX	1"	1 11/16"
GS 2020 FF - 20GS20FFORX	1 1/4"	1 11/16"

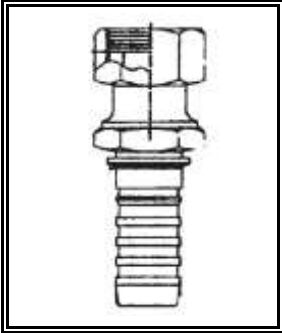

HEMBRA ASIENTO PLANO ORFS 45°		
REFERENCIA	MANGUERA	ROSCA ORFS
GS 0606 FF 45 - 06GS06FFORX45	3/8"	3/8"
GS 0608 FF 45 - 06GS08FFORX45	3/8"	1/2"
GS 0808 FF 45 - 08GS08FFORX45	1/2"	1/2"
GS 0810 FF 45 - 08GS10FFORX45	1/2"	5/8"
GS 1010 FF 45 - 10GS10FFORX45	5/8"	5/8"
GS 1212 FF 45 - 12GS12FFORX45	3/4"	3/4"
GS 1616 FF 45 - 16GS16FFORX45	1"	1"
GS 2020 FF 45 - 20GS20FFORX45	1 1/4"	1 1/4"

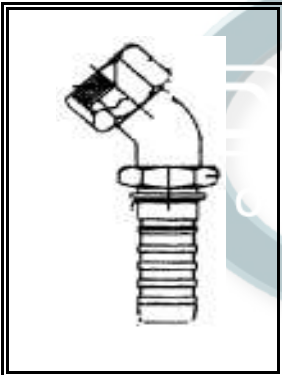

HEMBRA ASIENTO PLANO ORFS 90°		
REFERENCIA	MANGUERA	ROSCA ORFS
GS 0606 FF 90 - 06GS06FFORX90	3/8"	11/16"
GS 0808 FF 90 - 08GS08FFORX90	1/2"	13/16"
GS 0810 FF 90 - 08GS10FFORX90	1/2"	1"
GS 1010 FF 90 - 10GS10FFORX90	5/8"	1"
GS 1212 FF 90 - 12GS12FFORX90	3/4"	1 3/16"
GS 1216 FF 90 - 12GS16FFORX80	3/4"	1 7/16"
GS 1616 FF 90 - 16GS16FFORX90	1"	1 7/16"
GS 2020 FF 90 - 20GS20FFORX90	1 1/4"	1 11/16"

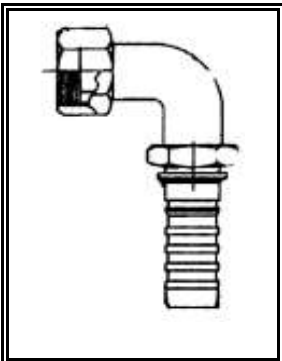

MACHO ASIENTO PLANO ORFS		
REFERENCIA	MANGUERA	ROSCA ORFS
GS 0606 FMO - 06GS06MFFOR	3/8"	3/8"
GS 0808 FMO - 08GS08MFFOR	1/2"	1/2"
GS 1212 FMO - 12GS12MFFOR	3/4"	3/4"
GS 1616 FMO - 16GS16MFFOR	1"	1"

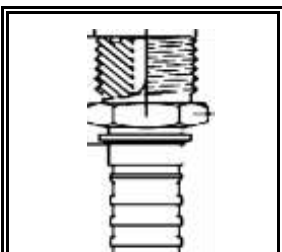

## CONEXIONES SERIE - GS

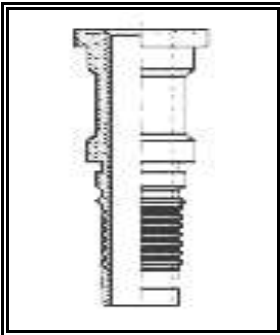

BRIDA SAE 3000 PSI		
REFERENCIA	MANGUERA	DIAM.
GS 0808 PA - 08GS08FL	1/2"	30,2
GS 0812 PA - 08GS12FL	1/2"	38,1
GS 1212 PA - 12GS12FL	3/4"	38,1
GS 1216 PA - 12GS16FL	3/4"	44,5
GS 1616 PA - 16GS16FL	1"	44,5
GS 1620 PA - 16GS20FL	1"	50,8
GS 2020 PA - 20GS20FL	1 1/4"	50,8

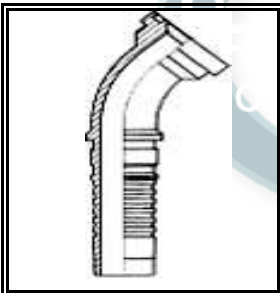

BRIDA SAE 3000 PSI 45°		
REFERENCIA	MANGUERA	DIAM.
GS 0812 PA 45 - 08GS12FL45	1/2"	30,2
GS 1212 PA 45 - 12GS12FL45	3/4"	38,1
GS 1216 PA 45 - 12GS16FL45	3/4"	44,5
GS 1616 PA 45 - 12GS16FL45	1"	44,5
GS 1620 PA 45 - 16GS20FL45	1"	50,8
GS 2020 PA 45 - 20GS20FL45	1 1/4"	50,8

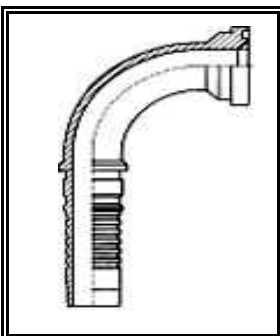

BRIDA SAE 3000 PSI 90°		
REFERENCIA	MANGUERA	DIAM.
GS 0808 PA 90 - 08GS08FL89	1/2"	30
GS 0812 PA 90 - 08GS12FL90	1/2"	38,1
GS 1212 PA 90 - 12GS12FL90	3/4"	38,1
GS 1216 PA 90 - 12GS16FL90	3/4"	44,5
GS 1616 PA 90 - 16GS16FL90	1"	44,5
GS 1620 PA 90 - 16GS20FL90	1"	50,8
GS 2020 PA 90 - 20GS20FL90	1 1/4"	50,8

## CONEXIONES SERIE - GS

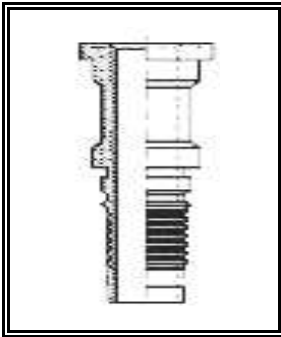

BRIDA SAE 6000 PSI		
REFERENCIA	MANGUERA	DIAM.
GS 0808 PH - 08GS08FLH	1/2"	31,8
GS 0812 PH - 08GS12FLH	1/2"	41,3
GS 1212 PH - 12GS12FLH	3/4"	41,3
GS 1216 PH - 12GS16FLH	3/4"	47,6
GS 1616 PH - 16GS16FLH	1"	47,6
GS 1620 PH - 16GS20FLH	1"	54
GS 2020 PH - 20GS20FLH	1 1/4"	54

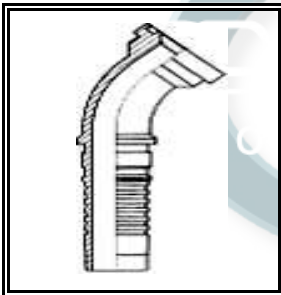

BRIDA SAE 6000 PSI 45°		
REFERENCIA	MANGUERA	DIAM.
GS 1212 PH 45 - 12GS12FLH45	3/4"	41,3
GS 1216 PH 45 - 12GS16FLH45	3/4"	47,6
GS 1616 PH 45 - 12GS16FLH45	1"	47,6
GS 1620 PH 45 - 16GS20FLH45	1"	54
GS 2020 PH 45 - 20GS20FLH45	1 1/4"	54

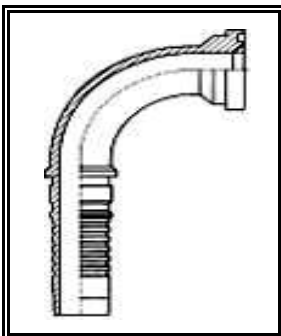

BRIDA SAE 6000 PSI 90°		
REFERENCIA	MANGUERA	DIAM.
GS 0808 PH 90 - 08GS08FLH90	1/2"	31,8
GS 1212 PH 90 - 12GS12FLH90	3/4"	41,3
GS 1216 PH 90 - 12GS16FLH90	3/4"	47,6
GS 1616 PH 90 - 16GS16FLH90	1"	47,6
GS 1620 PH 90 - 16GS20FLH90	1"	54
GS 2020 PH 90 - 20GS20FLH90	1 1/4"	54

## ADAPTADORES BSP

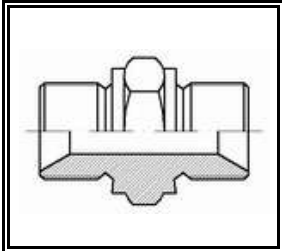

ADAPTADOR MACHO-MACHO BSP		
REFERENCIA	MACHO	MACHO
MM 0202	1/8"	1/8"
MM 0404	1/4"	1/4"
MM 0606	3/8"	3/8"
MM 0808	1/2"	1/2"
MM 1010	5/8"	5/8"
MM 1212	3/4"	3/4"
MM 1616	1"	1"
MM 2020	1 1/4"	1 1/4"
MM 2424	1 1/2"	1 1/2"
MM 3232	2"	2"

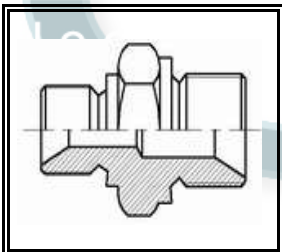

REDUCTOR MACHO-MACHO BSP		
REFERENCIA	MACHO	MACHO
MM 04 02	1/4"	1/8"
MM 06 02	3/8"	1/8"
MM 06 04	3/8"	1/4"
MM 08 04	1/2"	1/4"
MM 08 06	1/2"	3/8"
MM 12 06	3/4"	3/8"
MM 12 08	3/4"	1/2"
MM 16 08	1"	1/2"
MM 16 12	1"	3/4"
MM 20 12	1 1/4"	3/4"
MM 20 16	1 1/4"	1"
MM 24 16	1 1/2"	1"
MM 24 20	1 1/2"	1 1/4"
MM 32 20	2"	1 1/4"
MM 32 24	2"	1 1/2"

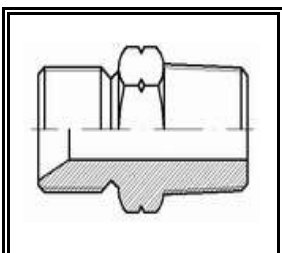

ADAPTADOR MACHO BSP-MACHO NPTF		
REFERENCIA	MACHO	MACHO
MNPT 04 04	1/4"	1/4"
MNPT 06 06	3/8"	3/8"
MNPT 08 08	1/2"	1/2"
MNPT 12 12	3/4"	3/4"
MNPT 16 16	1"	1"
MNPT 20 20	1 1/4"	1 1/4"
MNPT 24 24	1 1/2"	1 1/2"
MNPT 32 32	2"	2"

## ADAPTADORES BSP

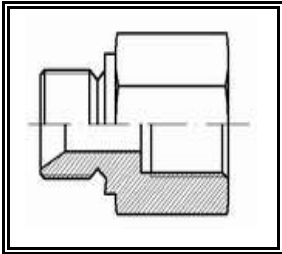

PROLONGADOR MACHO-HEMBRA FIJA BSP		
REFERENCIA	MACHO	HEMBRA
MHL 04 04	1/4"	1/4"
MHL 06 06	3/8"	3/8"
MHL 08 08	1/2"	1/2"
MHL 12 12	3/4"	3/4"
MHL 16 16	1"	1"
MHL 20 20	1 1/4"	1 1/4"
MHL 24 24	1 1/2"	1 1/2"
MHL 32 32	2"	2"

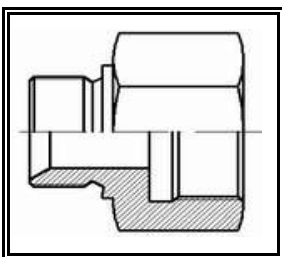

REDUCTOR MACHO-HEMBRA FIJA BSP		
REFERENCIA	MACHO	HEMBRA
MHL 02 04	1/8"	1/4"
MHL 04 02	1/4"	1/8"
MHL 04 06	1/4"	3/8"
MHL 04 08	1/4"	1/2"
MHL 06 02	3/8"	1/8"
MHL 06 04	3/8"	1/4"
MHL 06 08	3/8"	1/2"
MHL 06 12	3/8"	3/4"
MHL 08 04	1/2"	1/4"
MHL 08 06	1/2"	3/8"
MHL 08 12	1/2"	3/4"
MHL 12 06	3/4"	3/8"
MHL 12 08	3/4"	1/2"
MHL 12 16	3/4"	1"
MHL 16 12	1"	3/4"
MHL 16 20	1"	1 1/4"
MHL 20 12	1 1/4"	3/4"
MHL 20 16	1 1/4"	1"
MHL 20 24	1 1/4"	1 1/2"
MHL 24 20	1 1/2"	1 1/4"
MHL 24 32	1 1/2"	2"
MHL 32 24	2"	1 1/2"



## ADAPTADORES BSP

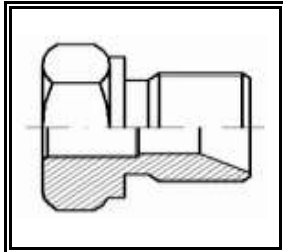

TAPÓN REDUCTOR MACHO-HEMбра FIJA BSP		
REFERENCIA	MACHO	HEMбра
MHC 04 02	1/4"	1/8"
MHC 06 02	3/8"	1/8"
MHC 06 04	3/8"	1/4"
MHC 08 04	1/2"	1/4"
MHC 08 06	1/2"	3/8"
MHC 12 06	3/4"	3/8"
MHC 12 08	3/4"	1/2"
MHC 16 08	1"	1/2"
MHC 16 12	1"	3/4"
MHC 20 12	1 1/4"	3/4"
MHC 20 16	1 1/4"	1"
MHC 24 16	1 1/2"	1"
MHC 24 20	1 1/2"	1 1/4"
MHC 32 20	2"	1 1/4"
MHC 32 24	2"	1 1/2"

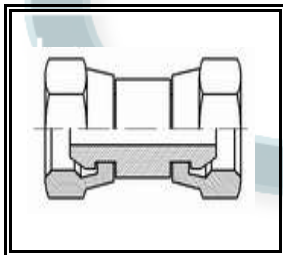

ADAPTADOR HEMбра GIRATORIA-HEMбра GIRATORIA BSP		
REFERENCIA	HEMбра	HEMбра
H22G 04	1/4"	1/4"
H22G 06	3/8"	3/8"
H22G 08	1/2"	1/2"
H22G 12	3/4"	3/4"
H22G 16	1"	1"

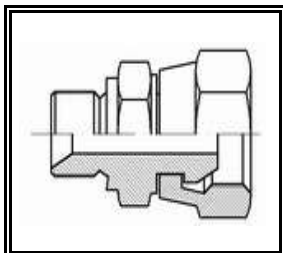

ADAPTADOR MACHO-HEMбра GIRATORIA BSP		
REFERENCIA	MACHO	HEMбра
M2G 02 04	1/8"	1/4"
M2G 04 04	1/4"	1/4"
M2G 04 06	1/4"	3/8"
M2G 06 06	3/8"	3/8"
M2G 06 08	3/8"	1/2"
M2G 08 08	1/2"	1/2"
M2G 08 12	1/2"	3/4"
M2G 12 12	3/4"	3/4"
M2G 12 16	3/4"	1"
M2G 16 16	1"	1"
M2G 16 20	1"	1 1/4"
M2G 20 20	1 1/4"	1 1/4"
M2G 20 24	1 1/4"	1 1/2"
M2G 24 24	1 1/2"	1 1/2"

## ADAPTADORES BSP

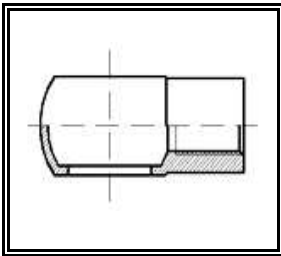

ESFÉRICO MACHO BSP	
REFERENCIA	HEMBRA
BAG 04	1/4"
BAG 06	3/8"
BAG 08	1/2"
BAG 12	3/4"
BAG 16	1"

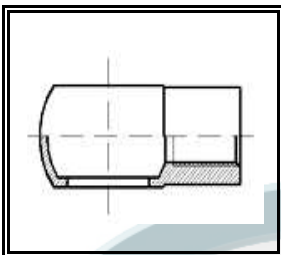

ESFÉRICO SOLDABLE BSP	
REFERENCIA	MACHO
BAGS 04	1/4"
BAGS 06	3/8"
BAGS 08	1/2"
BAGS 12	3/4"
BAGS 16	1"

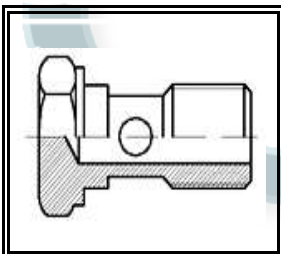

TORNILLO ORIENTABLE SIMPLE BSP	
REFERENCIA	MACHO
TBAG 04	1/4"
TBAG 06	3/8"
TBAG 08	1/2"
TBAG 12	3/4"
TBAG 16	1"

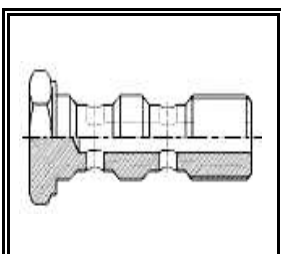

TORNILLO ORIENTABLE DOBLE BSP		
REFERENCIA	MACHO	PRECIO
TBAGD 04	1/4"	1,90 €
TBAGD 06	3/8"	2,64 €
TBAGD 08	1/2"	4,40 €
TBAGD 12	3/4"	5,94 €
TBAGD 16	1"	12,34 €

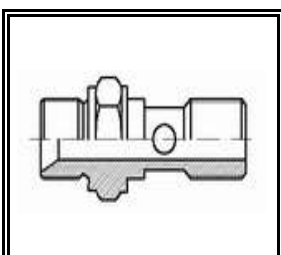

TORNILLO ORIENTABLE PROLONGADO BSP		
REFERENCIA	MACHO	MACHO
TBAGP 04 04	1/4"	1/4"
TBAGP 06 06	3/8"	3/8"
TBAGP 08 08	1/2"	1/2"
TBAGP 12 12	3/4"	3/4"
TBAGP 16 16	1"	1"

## ADAPTADORES BSP

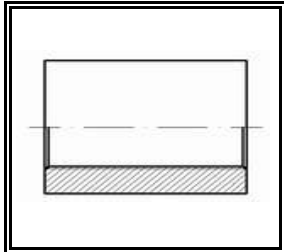

MANGUITO ROSCADO HEMBRA BSP REDONDO	
REFERENCIA	HEMBRA
HHG 02	1/8"
HHG 04	1/4"
HHG 06	3/8"
HHG 08	1/2"
HHG 12	3/4"
HHG 16	1"
HHG 20	1 1/4"
HHG 24	1 1/2"
HHG 32	2"

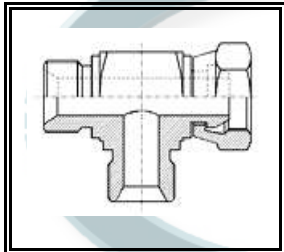

TE MACHO-MACHO-HEMBRA GIRATORIA LATERAL BSP		
REFERENCIA	MACHO	HEMBRA
T2MG 04	1/4"	1/4"
T2MG 06	3/8"	3/8"
T2MG 08	1/2"	1/2"
T2MG 12	3/4"	3/4"
T2MG 16	1"	1"

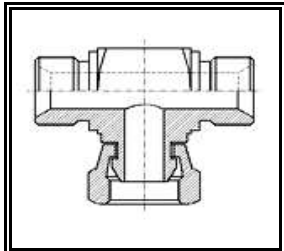

TE MACHO-MACHO-HEMBRA GIRATORIA CENTRAL BSP		
REFERENCIA	MACHO	HEMBRA
T3MG 04	1/4"	1/4"
T3MG 06	3/8"	3/8"
T3MG 08	1/2"	1/2"
T3MG 12	3/4"	3/4"
T3MG 16	1"	1"

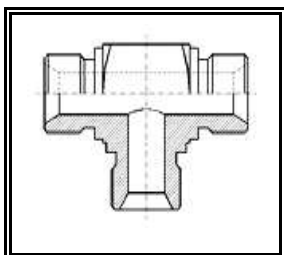

TE MACHO-MACHO-MACHO BSP		
REFERENCIA	MACHO	MACHO
TMG 04 04	1/4"	1/4"
TMG 06 06	3/8"	3/8"
TMG 08 08	1/2"	1/2"
TMG 12 12	3/4"	3/4"
TMG 16 16	1"	1"
TMG 20 20	1 1/4"	1 1/4"

## ADAPTADORES BSP

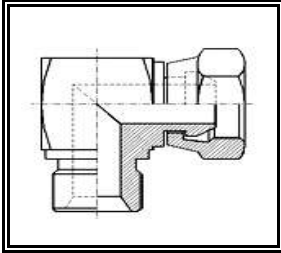

CODO MACHO-HEMBRA GIRATORIA 90° BLOQUE		
REFERENCIA	MACHO	HEMBRA
C2MG 04	1/4"	1/4"
C2MG 06	3/8"	3/8"
C2MG 08	1/2"	1/2"
C2MG 12	3/4"	3/4"
C2MG 16	1"	1"

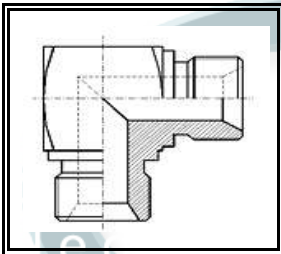

CODO MACHO-MACHO 90° BLOQUE		
REFERENCIA	MACHO	MACHO
CMM 04 04	1/4"	1/4"
CMM 04 06	1/4"	3/8"
CMM 06 06	3/8"	3/8"
CMM 06 08	3/8"	1/2"
CMM 08 08	1/2"	1/2"
CMM 08 12	1/2"	3/4"
CMM 12 12	3/4"	3/4"
CMM 12 16	3/4"	1"
CMM 16 16	1"	1"

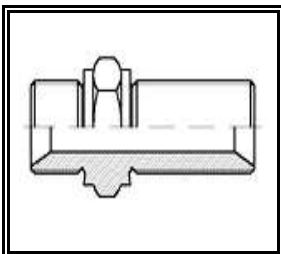

PASATABIQUES BSP	
REFERENCIA	MACHO
PG 04	1/4"
PG 06	3/8"
PG 08	1/2"
PG 12	3/4"
PG 16	1"

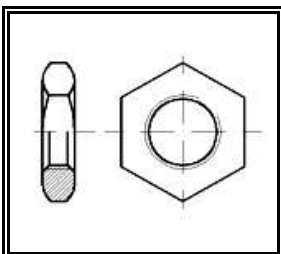

TUERCA PASATABIQUES	
REFERENCIA	HEMBRA
JPG 04	1/4"
JPG 06	3/8"
JPG 08	1/2"
JPG 12	3/4"
JPG 16	1"

## ADAPTADORES BSP

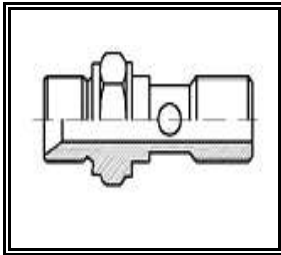

TORNILLO ORIENTABLE REDUCTOR BSP		
REFERENCIA	MACHO	MACHO
TBAGPR 04 06	1/4"	3/8"
TBAGPR 06 08	3/8"	1/2"
TBAGPR 08 12	1/2"	3/4"
TBAGPR 12 16	3/4"	1"

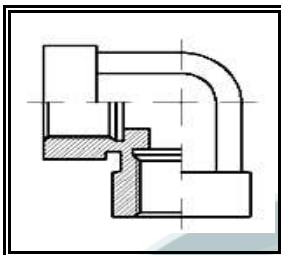

CODO HEMBRA FIJA-HEMBRA FIJA 90°		
REFERENCIA	MACHO	HEMBRA
CHG 04	1/4"	1/4"
CHG 06	3/8"	3/8"
CHG 08	1/2"	1/2"
CHG 12	3/4"	3/4"
CHG 16	1"	1"

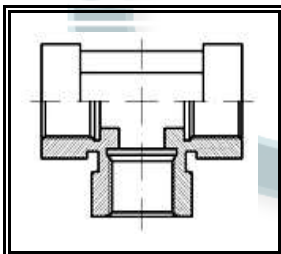

TE HEMBRA FIJA BSP	
REFERENCIA	MACHO
THG 04	1/4"
THG 06	3/8"
THG 08	1/2"
THG 12	3/4"
THG 16	1"

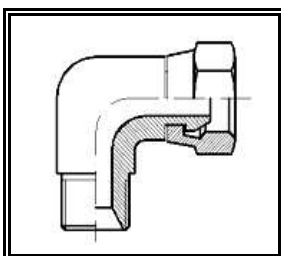

CODO REFORZADO MACHO-HEMBRA GIRATORIA BSP 90°		
REFERENCIA	MACHO	HEMBRA
C2MGR 04	1/4"	1/4"
C2MGR 06	3/8"	3/8"
C2MGR 08	1/2"	1/2"
C2MGR 12	3/4"	3/4"
C2MGR 16	1"	1"

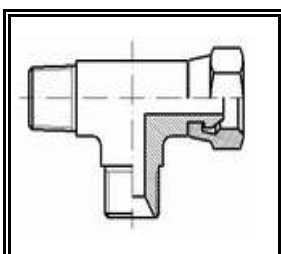

TE REFORZADA MACHO-HEMBRA GIRATORIA LATERAL		
REFERENCIA	MACHO	HEMBRA
T3MGR 04	1/4"	1/4"
T3MGR 06	3/8"	3/8"
T3MGR 08	1/2"	1/2"
T3MGR 12	3/4"	3/4"
T3MGR 16	1"	1"

## ADAPTADORES BSP

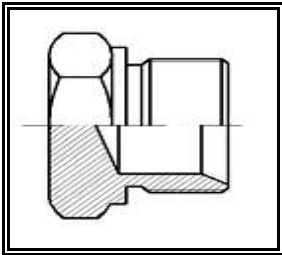

TAPÓN MACHO HEXAGONAL BSP	
REFERENCIA	MACHO
OG 02	1/8"
OG 04	1/4"
OG 06	3/8"
OG 08	1/2"
OG 12	3/4"
OG 16	1"
OG 20	1 1/4"
OG 24	1 1/2"
OG 32	2"

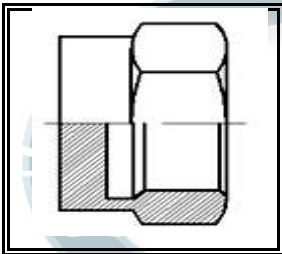

TAPÓN HEMBRA HEXAGONAL BSP	
REFERENCIA	HEMBRA
O2G 02	1/8"
O2G 04	1/4"
O2G 06	3/8"
O2G 08	1/2"
O2G 12	3/4"
O2G 16	1"
O2G 20	1 1/4"

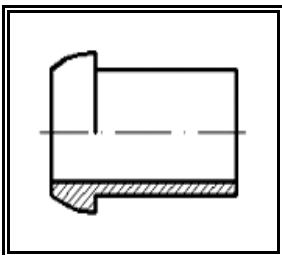

CONO DE AJUSTE	
REFERENCIA	ROSCA
CAG 04	1/4"
CAG 06	3/8"
CAG 08	1/2"
CAG 12	3/4"
CAG 16	1"
CAG 20	1 1/4"
CAG 24	1 1/2"
CAG 32	2"

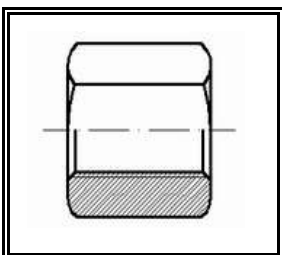

TUERCA UNIÓN APRIETE	
REFERENCIA	HEMBRA
JG 04	1/4"
JG 06	3/8"
JG 08	1/2"
JG 12	3/4"
JG 16	1"
JG 20	1 1/4 "
JG 24	1 1/2"
JG 32	2"

## ADAPTADORES BSP

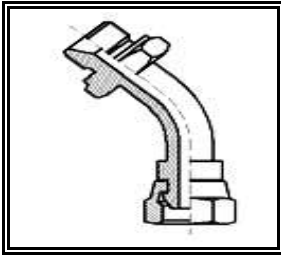

CODO MACHO-HEMBRA GIRATORIA 45° BSP		
REFERENCIA	MACHO	HEMBRA
V2SMG 04	1/4"	1/4"
V2SMG 06	3/8"	3/8"
V2SMG 08	1/2"	1/2"
V2SMG 12	3/4"	3/4"
V2SMG 16	1"	1"

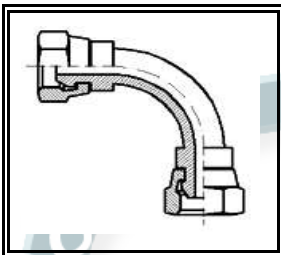

CODO HEMBRA GIR.-HEMBRA GIR 90° BSP		
REFERENCIA	HEMBRA	HEMBRA
C22G 04	1/4"	1/4"
C22G 06	3/8"	3/8"
C22G 08	1/2"	1/2"
C22G 12	3/4"	3/4"
C22G 16	1"	1"

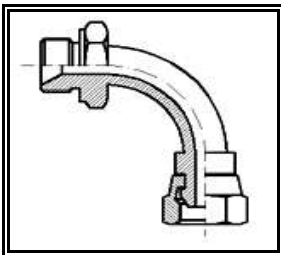

CODO MACHO-HEMBRA GIRATORIA 90° BSP		
REFERENCIA	MACHO	HEMBRA
C2SMG 02	1/8"	1/8"
C2SMG 04	1/4"	1/4"
C2SMG 06	3/8"	3/8"
C2SMG 08	1/2"	1/2"
C2SMG 12	3/4"	3/4"
C2SMG 16	1"	1"
C2SMG 20	1 1/4"	1 1/4"
C2SMG 24	1 1/2"	1 1/2"
C2SMG 32	2"	2"

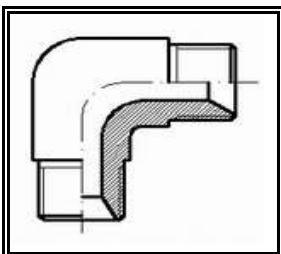

CODO MACHO-MACHO ORIENTABLE BSP		
REFERENCIA	MACHO	HEMBRA
CMOG 04	1/4"	1/4"
CMOG 06	3/8"	3/8"
CMOG 08	1/2"	1/2"
CMOG 12	3/4"	3/4"
CMOG 16	1"	1"

## ADAPTADORES BSP

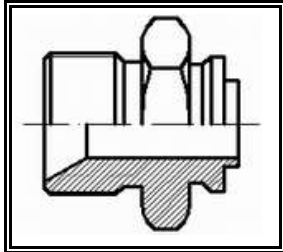

### RACOR MACHO BSP SOLDABLE EXTERNO

REFERENCIA	MACHO
MGS 02	1/8"
MGS 04	1/4"
MGS 06	3/8"
MGS 08	1/2"
MGS 12	3/4"
MGS 16	1"
MGS 20	1 1/4"
MGS 24	1 1/2"
MGS 32	2"

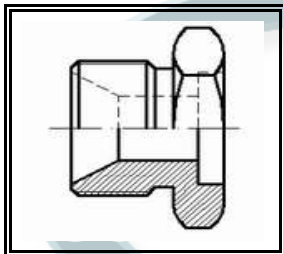

### RACOR MACHO BSP SOLDABLE INTERNO

REFERENCIA	MACHO
MSE 02	1/8"
MSE 04	1/4"
MSE 06	3/8"
MSE 08	1/2"
MSE 12	3/4"
MSE 16	1"
MSE 20	1 1/4"
MSE 24	1 1/2"

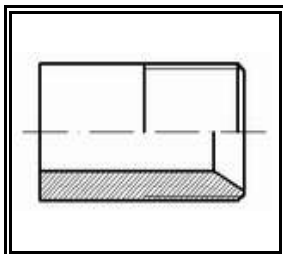

### UNIÓN LISA SOLDABLE BSP

REFERENCIA	MACHO
MSL 02	1/8"
MSL 04	1/4"
MSL 06	3/8"
MSL 08	1/2"
MSL 12	3/4"
MSL 16	1"
MSL 20	1 1/4"
MSL 24	1 1/2"
MSL 32	2"

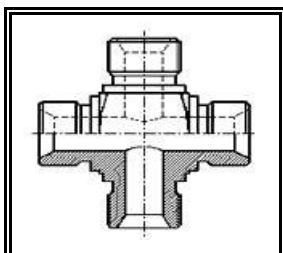

### CRUZ MACHO

REFERENCIA	MACHO
XMG 04	1/4"
XMG 06	3/8"
XMG 08	1/2"
XMG 12	3/4"
XMG 16	1"



## ADAPTADORES BSP

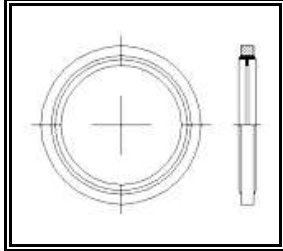

JUNTA METALBUNA BSP	
REFERENCIA	DIAM.
BS 02	1/8"
BS 04	1/4"
BS 06	3/8"
BS 08	1/2"
BS 12	3/4"
BS 16	1"
BS 20	1"1/4
BS 24	1"1/2
BS 32	2"

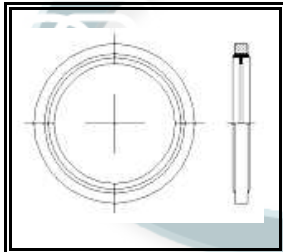

JUNTA METALBUNA METRICA	
REFERENCIA	DIAM.
BM 06	M.6
BM 08	M.8
BM 10	M.10
BM 12	M.12
BM 14	M.14
BM 16	M.16
BM 18	M.18
BM 20	M.20
BM 22	M.22
BM 24	M.24
BM 26	M.26
BM 28	M.28
BM 30	M.30

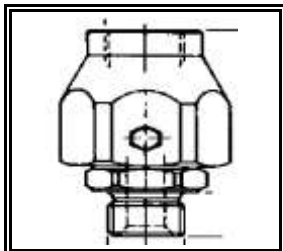

RACOR GIRATORIO RECTO BSP		
REFERENCIA	DIAM.	CAUDAL
GGL 1/4	1/4"	25
GGL 3/8	3/8"	38
GGL 1/2	1/2"	60
GGL 3/4	3/4"	100
GGL 1"	1"	180

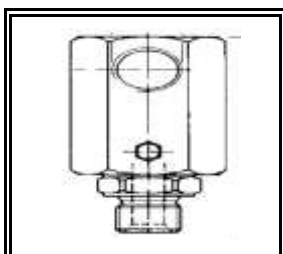

RACOR GIRATORIO CODO BSP		
REFERENCIA	DIAM.	CAUDAL
GGL 1/4 CODO	1/4"	25
GGL 3/8 CODO	3/8"	38
GGL 1/2 CODO	1/2"	60
GGL 3/4 CODO	3/4"	100
GGL 1" CODO	1"	180

## ADAPTADORES JIC 37°

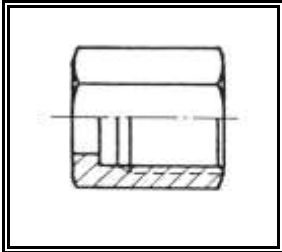

TUERCA JIC	
REFERENCIA	HEMBRA
J 04	7/16"
J 05	1/2"
J 06	9/16"
J 08	3/4"
J 10	7/8"
J 12	1 1/16"
J 16	1 5/16"
J 20	1 5/8"
J 24	1 7/8"

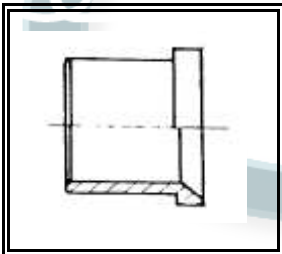

FÉRULA JIC	
REFERENCIA	TUBO
F 04	1/4"
F 05	5/16"
F 06	3/8"
F 08	1/2"
F 10	5/8"
F 12	3/4"
F 16	1"
F 20	1 1/4"
F 24	1 1/2"

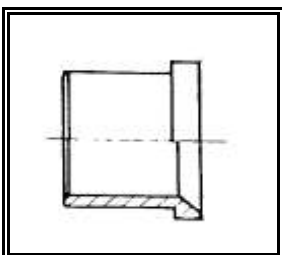

FÉRULA MÉTRICA	
REFERENCIA	TUBO
FM 06	6
FM 08	8
FM 10	10
FM 12	12
FM 15	15
FM 16	16
FM 18	18
FM 20	20
FM 25	25
FM 30	30

## ADAPTADORES JIC 37°

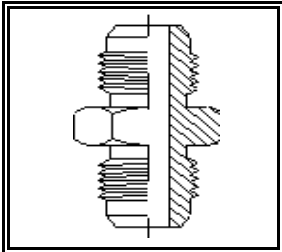

UNIÓN MACHO-MACHO JIC		
REFERENCIA	MACHO	MACHO
U 04	7/16"	7/16"
U 05	1/2"	1/2"
U 06	9/16"	9/16"
U 08	3/4"	3/4"
U 10	7/8"	7/8"
U 12	1 1/16"	1 1/16"
U 16	1 5/16"	1 5/16"
U 20	1 5/8"	1 5/8"
U 24	1 7/8"	1 7/8"

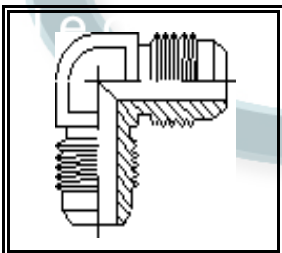

CODO MACHO-MACHO JIC 90°		
REFERENCIA	MACHO	MACHO
C 04	7/16"	7/16"
C 05	1/2"	1/2"
C 06	9/16"	9/16"
C 08	3/4"	3/4"
C 10	7/8"	7/8"
C 12	1 1/16"	1 1/16"
C 16	1 5/16"	1 5/16"
C 20	1 5/8"	1 5/8"

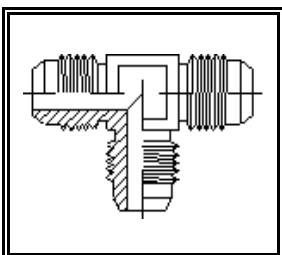

TE MACHO-MACHO-MACHO JIC		
REFERENCIA	MACHO	MACHO
T 04	7/16"	7/16"
T 05	1/2"	1/2"
T 06	9/16"	9/16"
T 08	3/4"	3/4"
T 10	7/8"	7/8"
T 12	1 1/16"	1 1/16"
T 16	1 5/16"	1 5/16"
T 20	1 5/8"	1 5/8"

## ADAPTADORES JIC 37°

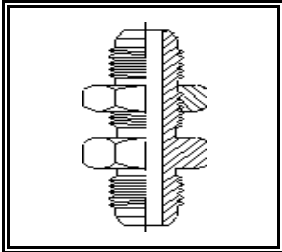

UNIÓN PASATABIQUES JIC		
REFERENCIA	MACHO	MACHO
P 04	7/16"	7/16"
P 05	1/2"	1/2"
P 06	9/16"	9/16"
P 08	3/4"	3/4"
P 10	7/8"	7/8"
P 12	1 1/16"	1 1/16"
P 16	1 5/16"	1 5/16"
P 20	1 5/8"	1 5/8"
P 24	1 7/8"	1 7/8"

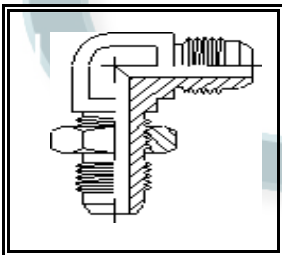

CODO PASATABIQUES JIC 90°		
REFERENCIA	MACHO	MACHO
CP 04	7/16"	7/16"
CP 05	1/2"	1/2"
CP 06	9/16"	9/16"
CP 08	3/4"	3/4"
CP 10	7/8"	7/8"
CP 12	1 1/16"	1 1/16"
CP 16	1 5/16"	1 5/16"

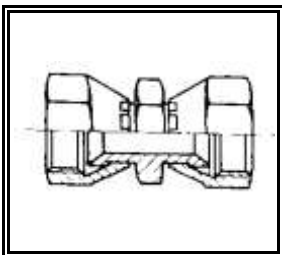

UNIÓN HEMBRA GIRATORIA JIC		
REFERENCIA	HEMBRA	HEMBRA
U22 04	7/16"	7/16"
U22 05	1/2"	1/2"
U22 06	9/16"	9/16"
U22 08	3/4"	3/4"
U22 10	7/8"	7/8"
U22 12	1 1/16"	1 1/16"
U22 16	1 5/16"	1 5/16"
U22 20	1 5/8"	1 5/8"
U22 24	1 7/8"	1 7/8"

## ADAPTADORES JIC 37°

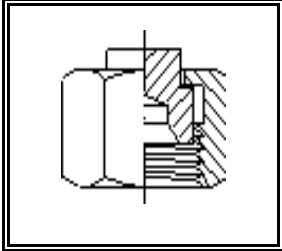

TAPÓN HEMBRA JIC	
REFERENCIA	HEMBRA
O2S 04	7/16"
O2S 05	1/2"
O2S 06	9/16"
O2S 08	3/4"
O2S 10	7/8"
O2S 12	1 1/16"
O2S 16	1 5/16"
O2S 20	1 5/8"
O2S 24	1 7/8"

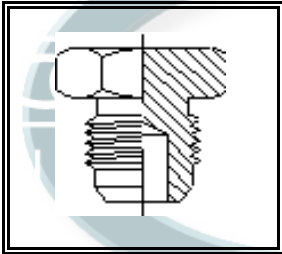

TAPÓN MACHO JIC	
REFERENCIA	MACHO
OS 04	7/16"
OS 05	1/2"
OS 06	9/16"
OS 08	3/4"
OS 10	7/8"
OS 12	1 1/16"
OS 16	1 5/16"
OS 20	1 5/8"
OS 24	1 7/8"

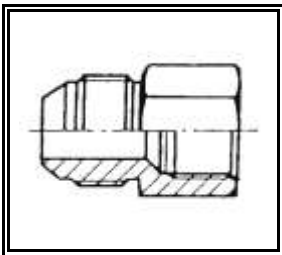

REDUCTOR MACHO-HEMBRA JIC		
REFERENCIA	MACHO	HEMBRA
HG 04 02	7/16"	1/8"
HG 04 04	7/16"	1/4"
HG 05 02	5/16"	1/8"
HG 05 04	5/16"	1/4"
HG 06 04	9/16"	1/4"
HG 06 06	9/16"	3/8"
HG 06 08	9/16"	1/2"
HG 08 04	3/4"	1/4"
HG 08 06	3/4"	3/8"
HG 08 08	3/4"	1/2"
HG 10 08	7/8"	1/2"
HG 12 08	1 1/16"	1/2"
HG 12 12	1 1/16"	3/4"
HG 16 16	1 5/16"	1"
HG 20 20	1 5/8"	1 1/4"
HG 24 24	1 7/8"	1 1/2"

## ADAPTADORES JIC 37°

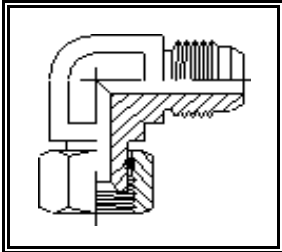

CODO MACHO-HEMBRA GIRATORIA JIC 90°		
REFERENCIA	MACHO	HEMBRA
C2 04	7/16"	7/16"
C2 05	1/2"	1/2"
C2 06	9/16"	9/16"
C2 08	3/4"	3/4"
C2 10	7/8"	7/8"
C2 12	1 1/16"	1 1/16"
C2 16	1 5/16"	1 5/16"
C2 20	1 5/8"	1 5/8"
C2 24	1 7/8"	1 7/8"

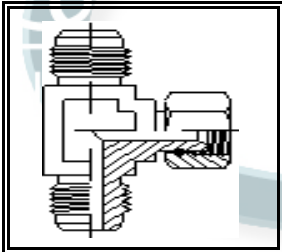

TE MACHO-MACHO-HEMBRA GIRATORIA CENTRAL		
REFERENCIA	MACHO	HEMBRA
T3 04	7/16"	7/16"
T3 05	1/2"	1/2"
T3 06	9/16"	9/16"
T3 08	3/4"	3/4"
T3 10	7/8"	7/8"
T3 12	1 1/16"	1 1/16"
T3 16	1 5/16"	1 5/16"
T3 20	1 5/8"	1 5/8"
T3 24	1 7/8"	1 7/8"

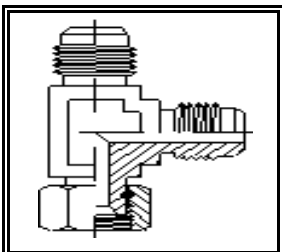

TE MACHO-MACHO-HEMBRA GIRATORIA LATERAL		
REFERENCIA	MACHO	HEMBRA
T2 04	7/16"	7/16"
T2 05	1/2"	1/2"
T2 06	9/16"	9/16"
T2 08	3/4"	3/4"
T2 10	7/8"	7/8"
T2 12	1 1/16"	1 1/16"
T2 16	1 5/16"	1 5/16"
T2 20	1 5/8"	1 5/8"
T2 24	1 7/8"	1 7/8"

## ADAPTADORES JIC 37°

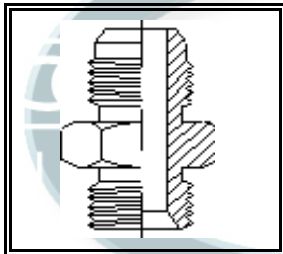

UNIÓN MACHO-MACHO JIC BSP		
REFERENCIA	MACHO JIC	MACHO BSP
RG 04 02	7/16"	1/8"
RG 04 04	7/16"	1/4"
RG 04 06	7/16"	3/8"
RG 04 08	7/16"	1/2"
RG 05 04	5/16"	1/4"
RG 05 06	5/16"	3/8"
RG 06 04	9/16"	1/4"
RG 06 06	9/16"	3/8"
RG 06 08	9/16"	1/2"
RG 08 04	3/4"	1/4"
RG 08 06	3/4"	3/8"
RG 08 08	3/4"	1/2"
RG 08 12	3/4"	3/4"
RG 10 06	7/8"	3/8"
RG 10 08	7/8"	1/2"
RG 10 12	7/8"	3/4"
RG 12 06	1"	3/8"
RG 12 08	1 1/16"	1/2"
RG 12 12	1 1/16"	3/4"
RG 12 16	1 1/16"	1"
RG 16 12	1 5/16"	3/4"
RG 16 16	1 5/16"	1"
RG 16 20	1 5/16"	1 1/4"
RG 16 24	1 5/16"	1 1/2"
RG 20 16	1 5/8"	1"
RG 20 20	1 5/8"	1 1/4"
RG 24 16	1 7/8"	1"
RG 24 20	1 7/8"	1 1/4"
RG 24 24	1 7/8"	1 1/2"

## ADAPTADORES JIC 37°

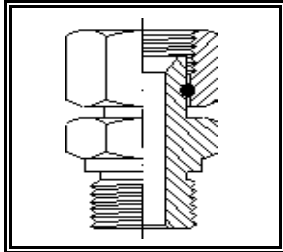

REDUCTOR HEMBRA-MACHO JIC BSP		
REFERENCIA	HEMBRA JIC	MACHO BSP
R2G 04 02	7/16"	1/8"
R2G 04 04	7/16"	1/4"
R2G 05 04	5/16"	1/4"
R2G 06 04	9/16"	1/4"
R2G 06 06	9/16"	3/8"
R2G 06 08	9/16"	1/2"
R2G 08 04	3/4"	1/4"
R2G 08 06	3/4"	3/8"
R2G 08 08	3/4"	1/2"
R2G 10 06	7/8"	3/8"
R2G 10 08	7/8"	1/2"
R2G 12 08	1 1/16"	1/2"
R2G 12 12	1 1/16"	3/4"
R2G 16 12	1 5/16"	3/4"
R2G 16 16	1 5/16"	1"
R2G 20 20	1 5/8"	1 1/4"
R2G 24 24	1 7/8"	1 1/2"

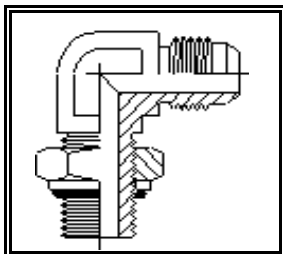

CODO MACHO-MACHO ORIENTABLE 90° JIC BSP		
REFERENCIA	MACHO JIC	MACHO BSP
CG 04 02	7/16"	1/8"
CG 04 04	7/16"	1/4"
CG 05 04	1/2"	1/4"
CG 06 04	9/16"	1/4"
CG 06 06	9/16"	3/8"
CG 06 08	9/16"	1/2"
CG 08 04	3/4"	1/4"
CG 08 06	3/4"	3/8"
CG 08 08	3/4"	1/2"
CG 08 12	3/4"	3/4"
CG 10 06	7/8"	3/8"
CG 10 08	7/8"	1/2"
CG 10 12	7/8"	3/4"
CG 12 08	1 1/16"	1/2"
CG 12 12	1 1/16"	3/4"
CG 16 12	1 5/16"	3/4"
CG 16 16	1 5/16"	1"
CG 16 20	1 5/16"	1 1/4"
CG 20 20	1 5/8"	1 1/4"
CG 24 24	1 7/8"	1 1/2"



## ADAPTADORES JIC 37°

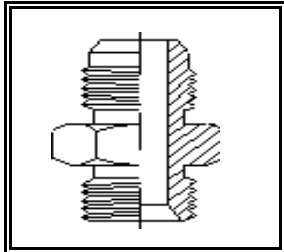

UNIÓN MACHO-MACHO JIC SAE		
REFERENCIA	MACHO JIC	MACHO SAE
RS 04 04	7/16"	7/16"
RS 04 05	7/16"	1/2"
RS 04 06	7/16"	9/16"
RS 05 05	1/2"	1/2"
RS 06 06	9/16"	9/16"
RS 06 08	9/16"	3/4"
RS 08 08	3/4"	3/4"
RS 08 10	3/4"	7/8"
RS 08 12	3/4"	1 1/16"
RS 10 08	7/8"	3/4"
RS 10 10	7/8"	7/8"
RS 10 12	7/8"	1" 1/16"
RS 12 08	1 1/16"	3/4"
RS 12 10	1 1/16"	7/8"
RS 12 12	1 1/16"	1 1/16"
RS 12 16	1 1/16"	1 5/16"
RS 16 12	1 5/16"	1 1/16"
RS 16 16	1 5/16"	1 5/16"
RS 16 20	1 5/16"	1 5/8"
RS 20 16	1 5/8"	1 5/16"
RS 20 20	1 5/8"	1"
RS 20 24	1 5/8"	1"
RS 24 24	1 7/8"	1 7/8"

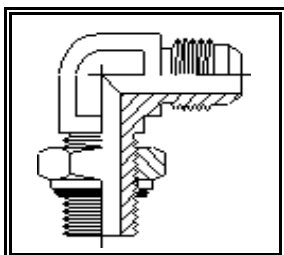

CODIGO MACHO-MACHO ORIENTABLE JIC SAE		
REFERENCIA	MACHO JIC	MACHO BSP
CS 04 04	7/16"	7/16"
CS 05 05	1/2"	1/2"
CS 06 06	9/16"	9/16"
CS 06 08	9/16"	3/4"
CS 08 08	3/4"	3/4"
CS 08 10	3/4"	7/8"
CS 10 10	7/8"	7/8"
CS 12 10	1 1/16"	7/8"
CS 12 12	1 1/16"	1 1/16"
CS 16 12	1 5/16"	1 1/16"
CS 16 16	1 5/16"	1 5/16"
CS 20 20	1 5/8"	1 5/8"

## ADAPTADORES JIC 37°

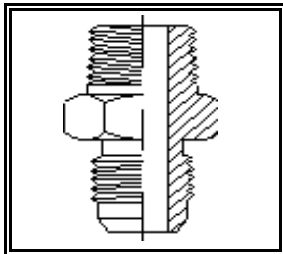

UNIÓN MACHO-MACHO JIC NPTF		
REFERENCIA	MACHO JIC	MACHO NPTF
RN 04 02	7/16"	1/8"
RN 04 04	7/16"	1/4"
RN 05 02	1/2"	1/8"
RN 05 04	1/2"	1/4"
RN 06 02	9/16"	1/8"
RN 06 04	9/16"	1/4"
RN 06 06	9/16"	3/8"
RN 06 08	9/16"	1/2"
RN 08 04	3/4"	1/4"
RN 08 06	3/4"	3/8"
RN 08 08	3/4"	1/2"
RN 08 12	3/4"	3/4"
RN 10 06	7/8"	3/8"
RN 10 08	7/8"	1/2"
RN 10 12	7/8"	3/4"
RN 12 08	1 1/16"	1/2"
RN 12 12	1 1/16"	3/4"
RN 12 16	1 1/16"	1"
RN 16 12	1 5/16"	3/4"
RN 16 16	1 5/16"	1"
RN 20 20	1 5/8"	1 1/4"

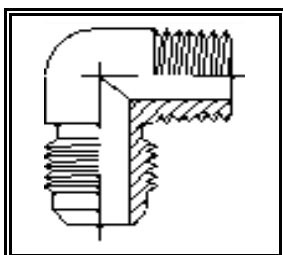

CODO MACHO-MACHO JIC NPTF		
REFERENCIA	MACHO JIC	MACHO NPTF
CN 04 02	7/16"	1/8"
CN 04 04	7/16"	1/4"
CN 05 02	1/2"	1/8"
CN 05 04	1/2"	1/4"
CN 06 02	9/16"	1/8"
CN 06 04	9/16"	1/4"
CN 06 06	9/16"	3/8"
CN 06 08	9/16"	1/2"
CN 08 04	3/4"	1/4"
CN 08 06	3/4"	3/8"
CN 08 08	3/4"	1/2"
CN 10 06	7/8"	3/8"
CN 10 08	7/8"	1/2"
CN 10 12	7/8"	3/4"
CN 12 08	1 1/16"	1/2"
CN 12 12	1 1/16"	3/4"
CN 16 12	1 5/16"	3/4"
CN 16 16	1 5/16"	1"

## ADAPTADORES JIC 37°

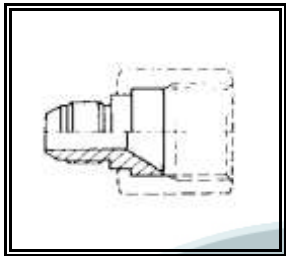

REDUCTOR MACHO HEMBRA JIC		
REFERENCIA	MACHO	HEMBRA
A 05 04	1/2"	7/16"
A 06 04	9/16"	7/16"
A 06 05	9/16"	1/2"
A 08 04	3/4"	7/16"
A 08 05	3/4"	1/2"
A 08 06	3/4"	9/16"
A 10 06	7/8"	9/16"
A 10 08	7/8"	3/4"
A 12 06	1 1/16"	9/16"
A 12 08	1 1/16"	3/4"
A 12 10	1 1/16"	7/8"
A 16 08	1 5/16"	3/4"
A 16 10	1 5/16"	7/8"
A 16 12	1 5/16"	1 1/16"
A 20 16	1 5/8"	1 5/16"

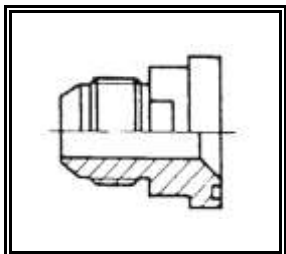

ADAPTADOR MACHO JIC A BRIDA SAE		
REFERENCIA	MACHO JIC	BRIDA SAE
K 08 08	3/4"	30,2
K 12 12	1 1/16"	38,1
K 12 16	1 1/16"	44,45
K 16 12	1 5/16"	38,1
K 16 16	1 5/16"	44,45
K 20 16	1 5/8"	44,45
K 20 20	1 5/8"	50,8
K 24 24	1 7/8"	60,32

## ADAPTADORES MÉTRICOS DIN 2353

### UNIÓN RECTA MÉTRICA SERIE LIIG.

REFERENCIA	TUBO
A 6-RL 1/8"	6
A 6-RL 1/4"	6
A 6-RL 3/8"	6
A 6-RL 1/2"	6
A 8-RL 1/8"	8
A 8-RL 1/4"	8
A 8-RL 3/8"	8
A 8-RL 1/2"	8
A 10-RL 1/4"	10
A 10-RL 3/8"	10
A 10-RL 1/2"	10
A 12-RL 1/4"	12
A 12-RL 3/8"	12
A 12-RL 1/2"	12
A 15-RL 3/8"	15
A 15-RL 1/2"	15
A 15-RL 3/4"	15
A 18-RL 3/8"	18
A 18-RL 1/2"	18
A 18-RL 3/4"	18
A 22-RL 1/2"	22
A 22-RL 3/4"	22
A 22-RL 1"	22
A 28-RL 3/4"	28
A 28-RL 1"	28
A 35-RL 1"	35
A 35-RL 1 1/4"	35
A 42-RL 1 1/2"	42

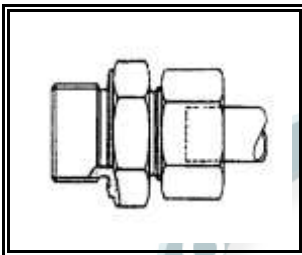

### UNIÓN RECTA MÉTRICA SERIE PES.

REFERENCIA	TUBO
A 6-RS 1/4"	6
A 6-RS 1/2"	6
A 8-RS 1/4"	8
A 8-RS 3/8"	8
A 10-RS 1/4"	10
A 10-RS 3/8"	10
A 10-RS 1/2"	10
A 12-RS 1/4"	12
A 12-RS 3/8"	12
A 12-RS 1/2"	12
A 14-RS 3/8"	14
A 14-RS 1/2"	14
A 16-RS 3/8"	16
A 16-RS 1/2"	16
A 16-RS 3/4"	16
A 20-RS 1/2"	20
A 20-RS 3/4"	20
A 25-RS 3/4"	25
A 25-RS 1"	25
A 30-RS 1"	30
A 30-RS 1 1/4"	30
A 38-RS 1"	38
A 38-RS 1 1/4"	38
A 38-RS 1 1/2"	38

### TUERCA MÉTRICA SERIE LIGERA

REFERENCIA	TUBO
M 6-L	6
M 8-L	8
M 10-L	10
M 12-L	12
M 15-L	15
M 18-L	18
M 22-L	22
M 28-L	28
M 35-L	35
M 42-L	42

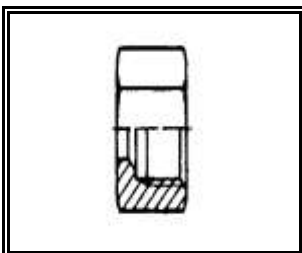

### TUERCA MÉTRICA SERIE PESADA

REFERENCIA	TUBO
M 6-S	6
M 8-S	8
M 10-S	10
M 12-S	12
M 14-S	14
M 16-S	16
M 20-S	20
M 25-S	25
M 30-S	30
M 38-S	38

# ADAPTADORES MÉTRICOS DIN 2353

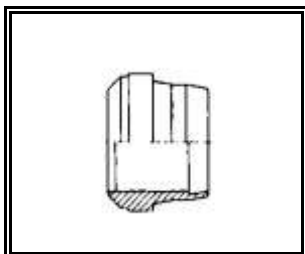

**ANILLO DE CORTE SERIE LIGERA**

REFERENCIA	TUBO
S 6-L	6
S 8-L	8
S 10-L	10
S 12-L	12
S 15-L	15
S 18-L	18
S 22-L	22
S 28-L	28
S 35-L	35
S 42-L	42

**ANILLO DE CORTE SERIE PESADA**

REFERENCIA	TUBO
S 6-S	6
S 8-S	8
S 10-S	10
S 12-S	12
S 14-S	14
S 16-S	16
S 20-S	20
S 25-S	25
S 30-S	30
S 38-S	38

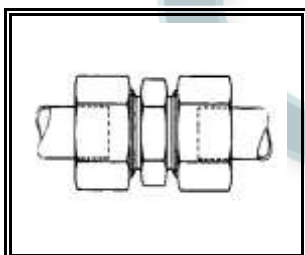

**UNIÓN IGUAL SERIE LIGERA**

REFERENCIA	TUBO
E 6-L	6
E 8-L	8
E 10-L	10
E 12-L	12
E 15-L	15
E 18-L	18
E 22-L	22
E 28-L	28
E 35-L	35
E 42-L	42

**UNIÓN IGUAL SERIE PESADA**

REFERENCIA	TUBO
E 6-S	6
E 8-S	8
E 10-S	10
E 12-S	12
E 14-S	14
E 16-S	16
E 20-S	20
E 25-S	25
E 30-S	30
E 38-S	38

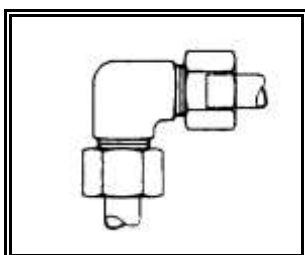

**CODO IGUAL SERIE LIGERA**

REFERENCIA	TUBO
F 6-L	6
F 8-L	8
F 10-L	10
F 12-L	12
F 15-L	15
F 18-L	18
F 22-L	22
F 28-L	28
F 35-L	35
F 42-L	42

**CODO IGUAL SERIE PESADA**

REFERENCIA	TUBO
F 6-S	6
F 8-S	8
F 10-S	10
F 12-S	12
F 14-S	14
F 16-S	16
F 20-S	20
F 25-S	25
F 30-S	30
F 38-S	38

# ADAPTADORES MÉTRICOS DIN 2353

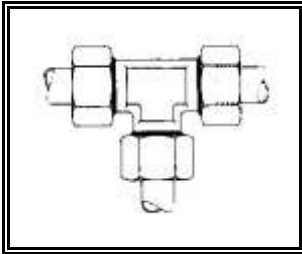

TE IGUAL SERIE LIGERA	
REFERENCIA	TUBO
G 6-L	6
G 8-L	8
G 10-L	10
G 12-L	12
G 15-L	15
G 18-L	18
G 22-L	22
G 28-L	28
G 35-L	35
G 42-L	42

TE IGUAL SERIE PESADA	
REFERENCIA	TUBO
G 6-S	6
G 8-S	8
G 10-S	10
G 12-S	12
G 14-S	14
G 16-S	16
G 20-S	20
G 25-S	25
G 30-S	30
G 38-S	38

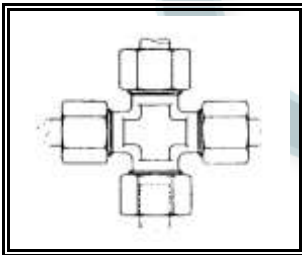

CRUZ IGUAL SERIE LIGERA	
REFERENCIA	TUBO
H 6-L	6
H 8-L	8
H 10-L	10
H 12-L	12
H 15-L	15
H 18-L	18
H 22-L	22
H 28-L	28
H 35-L	35
H 42-L	42

CRUZ IGUAL SERIE PESADA	
REFERENCIA	TUBO
H 6-S	6
H 8-S	8
H 10-S	10
H 12-S	12
H 14-S	14
H 16-S	16
H 20-S	20
H 25-S	25
H 30-S	30
H 38-S	38

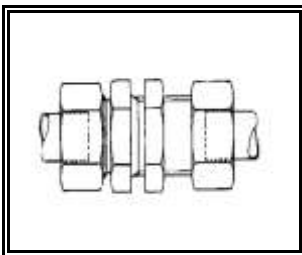

PASATABIQUE SERIE LIGERA	
REFERENCIA	TUBO
K 6-L	6
K 8-L	8
K 10-L	10
K 12-L	12
K 15-L	15
K 18-L	18
K 22-L	22
K 28-L	28
K 35-L	35
K 42-L	42

PASATABIQUE SERIE PESADA	
REFERENCIA	TUBO
K 6-S	6
K 8-S	8
K 10-S	10
K 12-S	12
K 14-S	14
K 16-S	16
K 20-S	20
K 25-S	25
K 30-S	30
K 38-S	38

## ADAPTADORES MÉTRICOS DIN 2353

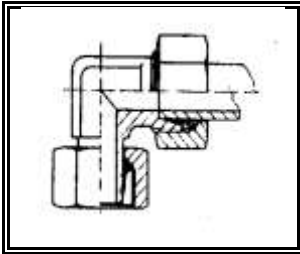

### CODO HEMBRA T.L. SERIE LIGERA

REFERENCIA	TUBO
VB 6-L	6
VB 8-L	8
VB 10-L	10
VB 12-L	12
VB 15-L	15
VB 18-L	18
VB 22-L	22
VB 28-L	28
VB 35-L	35
VB 42-L	42

### CODO HEMBRA T.L. SERIE PESADA

REFERENCIA	TUBO
VB 6-S	6
VB 8-S	8
VB 10-S	10
VB 12-S	12
VB 14-S	14
VB 16-S	16
VB 20-S	20
VB 25-S	25
VB 30-S	30
VB 38-S	38

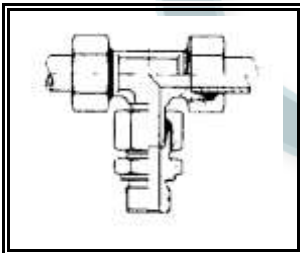

### TE HEMBRA T.L. CENTRAL S/LIGERA

REFERENCIA	TUBO
VC 6-L	6
VC 8-L	8
VC 10-L	10
VC 12-L	12
VC 15-L	15
VC 18-L	18
VC 22-L	22
VC 28-L	28
VC 35-L	35
VC 42-L	42

### TE HEMBRA T.L. CENTRAL S/ PESADA

REFERENCIA	TUBO
VC 6-S	6
VC 8-S	8
VC 10-S	10
VC 12-S	12
VC 14-S	14
VC 16-S	16
VC 20-S	20
VC 25-S	25
VC 30-S	30
VC 38-S	38

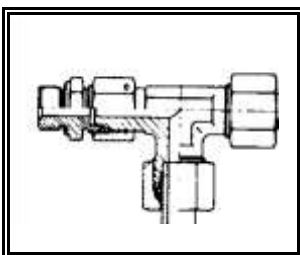

### TE HEMBRA T.L. LATERAL S/ LIGERA

REFERENCIA	TUBO
VD 6-L	6
VD 8-L	8
VD 10-L	10
VD 12-L	12
VD 15-L	15
VD 18-L	18
VD 22-L	22
VD 28-L	28
VD 35-L	35
VD 42-L	42

### TE HEMBRA T.L. LATERAL S/ PESADA

REFERENCIA	TUBO
VD 6-S	6
VD 8-S	8
VD 10-S	10
VD 12-S	12
VD 14-S	14
VD 16-S	16
VD 20-S	20
VD 25-S	25
VD 30-S	30
VD 38-S	38

# ADAPTADORES MÉTRICOS DIN 2353

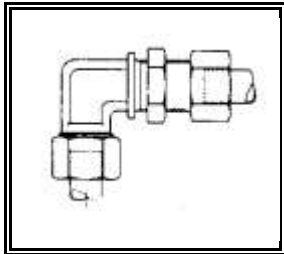

CODO PASATABIQUES SERIE LIGERA	
REFERENCIA	TUBO
L 6-L	6
L 8-L	8
L 10-L	10
L 12-L	12
L 15-L	15
L 18-L	18
L 22-L	22
L 28-L	28
L 35-L	35
L 42-L	42

CODO PASATABIQUES SERIE PESADA	
REFERENCIA	TUBO
L 6-S	6
L 8-S	8
L 10-S	10
L 12-S	12
L 14-S	14
L 16-S	16
L 20-S	20
L 25-S	25
L 30-S	30
L 38-S	38

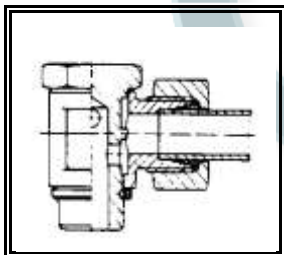

CODO ORIENTABLE SERIE LIGERA	
REFERENCIA	TUBO
SBD 6-RL 1/8"	6
SBD 8-RL 1/4"	8
SBD 10-RL 1/4"	10
SBD 12-RL 3/8"	12
SBD 15-RL 1/2"	15
SBD 18-RL 1/2"	18
SBD 22-RL 3/4"	22

CODO ORIENTABLE SERIE PESADA	
REFERENCIA	TUBO
SBD 6-RS 1/8"	6
SBD 8-RS 1/4"	8
SBD 10-RS 1/4"	10
SBD 12-RS 3/8"	12
SBD 14-RS 1/2"	14
SBD 16-RS 1/2"	16
SBD 20-RS 3/4"	20

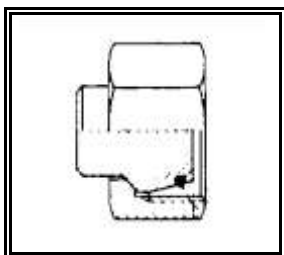

TAPÓN CÓNICO SERIE LIGERA	
REFERENCIA	TUBO
STO 6-L	6
STO 8-L	8
STO 10-L	10
STO 12-L	12
STO 15-L	15
STO 18-L	18
STO 22-L	22
STO 28-L	28
STO 35-L	35
STO 42-L	42

TAPÓN CÓNICO SERIE PESADA	
REFERENCIA	TUBO
STO 6-S	6
STO 8-S	8
STO 10-S	10
STO 12-S	12
STO 14-S	14
STO 16-S	16
STO 20-S	20
STO 25-S	25
STO 30-S	30
STO 38-S	38



## ADAPTADORES MÉTRICOS DIN 2353

REDUCCIÓN HEMBRA T.L. S/ LIG.	
REFERENCIA	
RL 8/6	
RL 10/6	
RL 10/8	
RL 12/6	
RL 12/8	
RL 12/10	
RL 15/6	
RL 15/8	
RL 15/10	
RL 15/12	
RL 18/8	
RL 18/10	
RL 18/12	
RL 18/15	
RL 22/10	
RL 22/12	
RL 22/15	
RL 22/18	
RL 28/10	
RL 28/12	
RL 28/15	
RL 28/18	
RL 28/22	
RL 35/12	
RL 35/22	
RL 35/28	
RL 42/18	
RL 42/22	
RL 42/28	
RL 42/35	

REDUCCIÓN HEMBRA T.L. S/ PES.	
REFERENCIA	
RS 8/6	
RS 10/6	
RS 10/8	
RS 12/6	
RS 12/8	
RS 12/10	
RS 14/6	
RS 14/8	
RS 14/10	
RS 14/12	
RS 16/8	
RS 16/10	
RS 16/12	
RS 18/14	
RS 20/10	
RS 20/12	
RS 20/14	
RS 20/16	
RS 25/10	
RS 25/12	
RS 25/14	
RS 25/16	
RS 25/20	
RS 30/12	
RS 30/20	
RS 30/25	
RS 38/16	
RS 38//20	
RS 38/25	
RS 38/30	

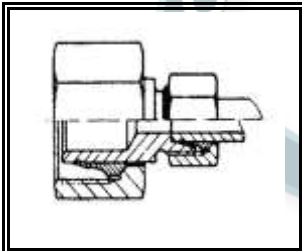

## ADAPTADORES MÉTRICOS DIN 2353

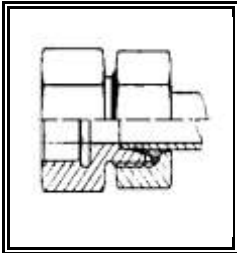

UNIÓN HEMBRA BSP SERIE LIGERA	
REFERENCIA	TUBO
AI 6-L/R 1/8"	6
AI 8-L/R 1/4"	8
AI 8-L/R 3/8"	8
AI 10-L/R 1/4"	10
AI 10-L/R 3/8"	10
AI 12-L/R 3/8"	12
AI 12-L/R 1/2"	12
AI 15-L/R 1/2"	15
AI 18-L/R 1/2"	18
AI 22-L/R 3/4"	22
AI 28-L/R 1"	28
AI 35-L/R 1 1/4"	35
AI 42-L/R 1 1/2"	42

UNIÓN HEMBRA BSP SERIE PESADA	
REFERENCIA	TUBO
AI 6-S/R 1/4	6
AI 8-S/R 1/4"	8
AI 10-S/R 3/8"	10
AI 12-S/R 3/8"	12
AI 14-S/R 1/2"	14
AI 16-S/R 1/2"	16
AI 20-S/R 3/4"	20
AI 25-S/R 1"	25
AI 30-S/R 1 1/4"	30
AI 38-S/R 1 1/2"	38

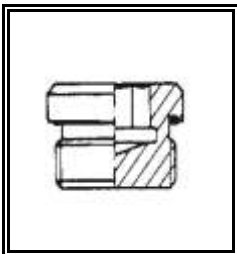

TAPÓN ALLEN MÉTRICO	
REFERENCIA	
VSCH M 10X1	
VSCH M 12X1,5	
VSCH M 14X1,5	
VSCH M 16X1,5	
VSCH M 18X1,5	
VSCH M 20X1,5	
VSCH M 22X1,5	
VSCH M 26X1,5	
VSCH M 27X2	
VSCH M 33X2	
VSCH M 42X2	

TAPÓN ALLEN BSP	
REFERENCIA	
VSCH R 1/8"	
VSCH R 1/4"	
VSCH R 3/8"	
VSCH R 1/2"	
VSCH R 3/4"	
VSCH R 1"	
VSCH R 1 1/4"	
VSCH R 1 1/2"	

## ADAPTADORES ORFS



UNIÓN MACHO-MACHO ORFS		
REFERENCIA	MACHO	MACHO
MMF 04	9/16" - 18	9/16" - 18
MMF 06	11/16" - 16	11/16" - 16
MMF 08	13/16" - 16	13/16" - 16
MMF 10	1" - 14	1" - 14
MMF 12	1 3/16" - 12	1 3/16" - 12
MMF 16	1 7/16" - 12	1 7/16" - 12
MMF 20	1 11/16" - 12	1 11/16" - 12
MMF 24	2" - 12	2" - 12



CODO MACHO-MACHO ORFS		
REFERENCIA	MACHO	MACHO
CF 04	9/16" - 18	9/16" - 18
CF 06	11/16" - 16	11/16" - 16
CF 08	13/16" - 16	13/16" - 16
CF 10	1" - 14	1" - 14
CF 12	1 3/16" - 12	1 3/16" - 12
CF 16	1 7/16" - 12	1 7/16" - 12



TE MACHO-MACHO-MACHO ORFS		
REFERENCIA	MACHO	MACHO
TF 04	9/16" - 18	9/16" - 18
TF 06	11/16" - 16	11/16" - 16
TF 08	13/16" - 16	13/16" - 16
TF 10	1" - 14	1" - 14
TF 12	1 3/16" - 12	1 3/16" - 12
TF 16	1 7/16" - 12	1 7/16" - 12



CODO ORIENTABLE 90° ORFS-SAE		
REFERENCIA	MACHO ORFS	MACHO SAE
CFS 04 04	9/16" - 18	7/16"
CFS 06 06	11/16" - 16	9/16"
CFS 08 08	13/16" - 16	3/4"
CFS 10 08	1" - 14	3/4"
CFS 12 12	1 3/16" - 12	1 1/16"
CFS 16 16	1 7/16" - 12	1 5/16"

## ADAPTADORES ORFS



CODO MACHO-HEMBRA GIRATORIA 90° ORFS		
REFERENCIA	MACHO	HEMBRA
C2F 04	9/16" - 18	9/16" - 18
C2F 06	11/16" - 16	11/16" - 16
C2F 08	13/16" - 16	13/16" - 16
C2F 10	1" - 14	1" - 14
C2F 12	1 3/16" - 12	1 3/16" - 12
C2F 16	1 7/16" - 12	1 7/16" - 12



TE MACHO-MACHO-HEMBRA GIRATORIA CENTRAL ORFS		
REFERENCIA	MACHO	HEMBRA
T3F 04	9/16" - 18	9/16" - 18
T3F 06	11/16" - 16	11/16" - 16
T3F 08	13/16" - 16	13/16" - 16
T3F 10	1" - 14	1" - 14
T3F 12	1 3/16" - 12	1 3/16" - 12
T3F 16	1 7/16" - 12	1 7/16" - 12



TE MACHO-MACHO-HEMBRA GIRATORIA LATERAL ORFS		
REFERENCIA	MACHO	HEMBRA
T2F 04	9/16" - 18	9/16" - 18
T2F 06	11/16" - 16	11/16" - 16
T2F 08	13/16" - 16	13/16" - 16
T2F 10	1" - 14	1" - 14
T2F 12	1 3/16" - 12	1 3/16" - 12
T2F 16	1 7/16" - 12	1 7/16" - 12



UNIÓN MACHO-MACHO ORFS-SAE		
REFERENCIA	MACHO	MACHO SAE
MMFS 04 04	9/16" - 18	7/16"
MMFS 06 06	11/16" - 16	9/16"
MMFS 08 08	13/16" - 16	3/4"
MMFS 10 10	1" - 14	7/8"
MMFS 12 12	1 3/16" - 12	1 1/16"
MMFS 16 16	1 7/16" - 12	1 5/16"

## ADAPTADORES ORFS



UNIÓN PASATABIQUES ORFS		
REFERENCIA	MACHO	HEMBRA
PF 04	9/16" - 18	9/16" - 18
PF 06	11/16" - 16	11/16" - 16
PF 08	13/16" - 16	13/16" - 16
PF 10	1" - 14	1" - 14
PF 12	1 3/16" - 12	1 3/16" - 12
PF 16	1 7/16" - 12	1 7/16" - 12



CODO PASATABIQUES 90° ORFS		
REFERENCIA	MACHO	HEMBRA
CPF 04	9/16" - 18	9/16" - 18
CPF 06	11/16" - 16	11/16" - 16
CPF 08	13/16" - 16	13/16" - 16
CPF 10	1" - 14	1" - 14
CPF 12	1 3/16" - 12	1 3/16" - 12
CPF 16	1 7/16" - 12	1 7/16" - 12



CODO MACHO-MACHO ORIENTABLE ORFS-BSP		
REFERENCIA	MACHO	HEMBRA
CFG 04 04	9/16" - 18	1/4"
CFG 06 06	11/16" - 16	3/8"
CFG 08 08	13/16" - 16	1/2"
CFG 10 08	1" - 14	1/2"
CFG 12 12	1 3/16" - 12	3/4"
CFG 16 16	1 7/16" - 12	1"



UNIÓN MACHO-MACHO ORFS-NPT		
REFERENCIA	MACHO ORFS	MACHO SAE
MMFT 04 02	9/16" - 18	1/8"
MMFT 04 04	9/16" - 19	1/4"
MMFT 06 04	11/16" - 16	1/4"
MMFT 06 06	11/16" - 17	3/8"
MMFT 08 06	13/16" - 16	3/8"
MMFT 08 08	13/16" - 17	1/2"
MMFT 10 08	1" - 14	1/2"
MMFT 12 12	1 3/16" - 12	3/4"
MMFT 16 16	1 7/16" - 12	1"

## ADAPTADORES ORFS



TUERCA ORFS	
REFERENCIA	HEMBRA
JF 04	9/16" - 18
JF 06	11/16" - 16
JF 08	13/16" - 16
JF 10	1" - 14
JF 12	1 3/16" - 12
JF 16	1 7/16" - 12
JF 20	1 11/16" - 12
JF 24	2" - 12



MACHO SOLDABLE ORFS	
REFERENCIA	MACHO
MFS 04	9/16" - 18
MFS 06	11/16" - 16
MFS 08	13/16" - 16
MFS 10	1" - 14
MFS 12	1 3/16" - 12
MFS 16	1 7/16" - 12
MFS 20	1 11/16" - 12
MFS 24	2" - 12



REDUCTOR MACHO-MACHO ORFS		
REFERENCIA	MACHO ORFS	MACHO BSP
MMFG 04 02	9/16" - 18	1/8"
MMFG 04 04	9/16" - 18	1/4"
MMFG 06 04	11/16" - 16	1/4"
MMFG 06 06	11/16" - 16	3/8"
MMFG 08 06	13/16" - 16	3/8"
MMFG 08 08	13/16" - 16	1/2"
MMFG 10 08	1" - 14	1/2"
MMFG 12 12	1 3/16" - 12	3/4"
MMFG 16 12	1" - 12	3/4"
MMFG 16 16	1 7/16" - 12	1"
MMFG 20 20	1 11/16" - 12	1 1/4"
MMFG 24 24	2" - 12	1 1/2"

## ADAPTADORES ORFS



TAPÓN HEMBRA ORFS	
REFERENCIA	MACHO
O2F 04	9/16" - 18
O2F 06	11/16" - 16
O2F 08	13/16" - 16
O2F 10	1" - 14
O2F 12	1 3/16" - 12
O2F 16	1 7/16" - 12
O2F 20	1 11/16" - 12
O2F 24	2" - 12



TAPÓN MACHO ORFS	
REFERENCIA	MACHO
OF 04	9/16" - 18
OF 06	11/16" - 16
OF 08	13/16" - 16
OF 10	1" - 14
OF 12	1 3/16" - 12
OF 16	1 7/16" - 12
OF 20	1 11/16" - 12
OF 24	2" - 12

## ENCHUFES RÁPIDOS

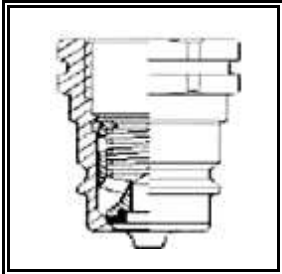

<b>ENCHUFE RÁPIDO MACHO DE PUNZÓN</b>	
REFERENCIA	ROSCA
ERM 04	1/4"
ERM 06	3/8"
ERM 08	1/2"
ERM 12	3/4"
ERM 16	1"
ERM 20	1 1/4"
ERM 24	1 1/2"

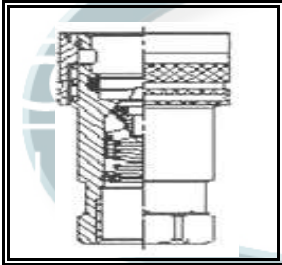

<b>ENCHUFE RÁPIDO HEMBRA DE PUNZÓN</b>	
REFERENCIA	ROSCA
ERH 04	1/4"
ERH 06	3/8"
ERH 08	1/2"
ERH 12	3/4"
ERH 16	1"
ERH 20	1 1/4"
ERH 24	1 1/2"

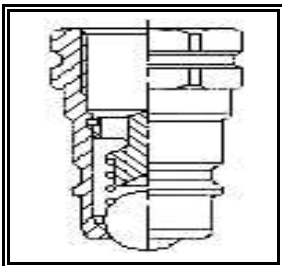

<b>ENCHUFE RÁPIDO MACHO DE BOLA</b>	
REFERENCIA	ROSCA
ERBM 04	1/4"
ERBM 06	3/8"
ERBM 08	1/2"
ERBM 12	3/4"
ERBM 16	1"
ERBM 20	1 1/4"

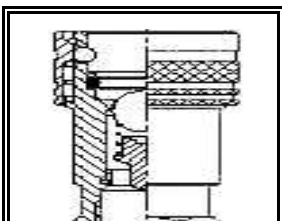

<b>ENCHUFE RÁPIDO HEMBRA DE BOLA</b>	
REFERENCIA	ROSCA
ERBH 04	1/4"
ERBH 06	3/8"
ERBH 08	1/2"
ERBH 12	3/4"
ERBH 16	1"



## ENCHUFES RÁPIDOS

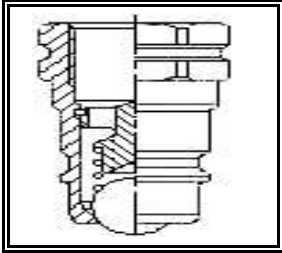

**ENCHUFE RÁPIDO MACHO DE BOLA TAZ**

REFERENCIA	ROSCA
ERBM 08 TAZ	3/8"
ERBM 12 TAZ	1/2"
ERBM 16 TAZ	3/4"

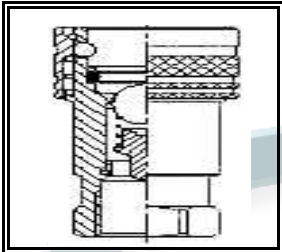

**ENCHUFE RÁPIDO HEMBRA DE BOLA TAZ**

REFERENCIA	ROSCA
ERBH 08 TAZ	1/2"
ERBH 12 TAZ	3/4"
ERBH 16 TAZ	1"

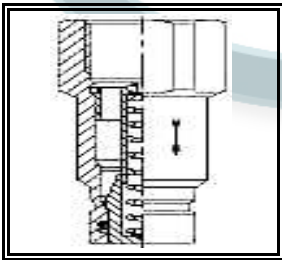

**ENCHUFE RÁPIDO PLANO MACHO**

REFERENCIA	ROSCA
ERPM 04	1/4"
ERPM 06	3/8"
ERPM 08	1/2"
ERPM 12	3/4"
ERPM 16	1"

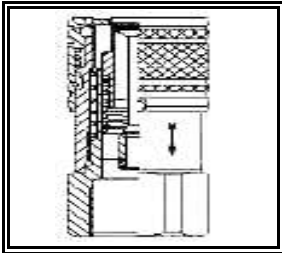

**ENCHUFE RÁPIDO PLANO HEMBRA**

REFERENCIA	ROSCA
ERPH 04	1/4"
ERPH 06	3/8"
ERPH 08	1/2"
ERPH 12	3/4"
ERPH 16	1"

## LLAVES DE PASO

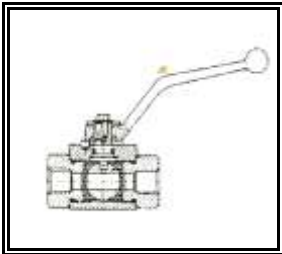

LLAVE DE PASO DE 2 VÍAS	
REFERENCIA	ROSCA
V2 04	1/4"
V2 06	3/8"
V2 08	1/2"
V2 12	3/4"
V2 16	1"
V2 20	1 1/4"
V2 24	1 1/2"

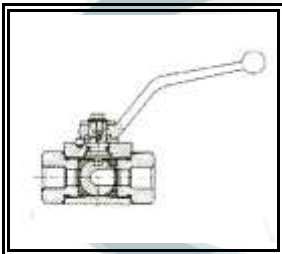

LLAVE DE PASO DE 3 VÍAS	
REFERENCIA	ROSCA
V3 04	1/4"
V3 06	3/8"
V3 08	1/2"
V3 12	3/4"
V3 16	1"

## ABRAZADERAS SIMPLES

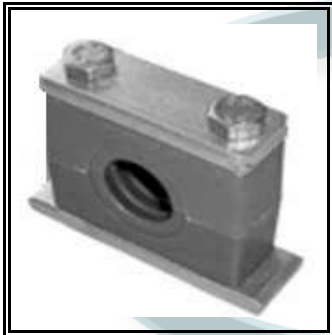

ABRAZADERAS SIMPLES	
REFERENCIA	VASTAGO
ABS 6	6
ABS 8	8
ABS 10	10
ABS 12	12
ABS 1/4"	13,5
ABS 14	14
ABS 15	15
ABS 16	16
ABS 3/8"	17,2
ABS 18	18
ABS 20	20
ABS 1/2"	21,3
ABS 22	22
ABS 25	25
ABS 3/4"	26,9
ABS 28	28
ABS 30	30
ABS 32	32
ABS 1"	33,7
ABS 35	35
ABS 38	38
ABS 42	42
ABS 1 1/2"	48,3
ABS 50	50

## ABRAZADERAS DOBLES



ABRAZADERAS DOBLES	
REFERENCIA	VASTAGO
ABD 6	6
ABD 8	8
ABD 10	10
ABD 12	12
ABD 12.7	12,7
ABD 1/4"	13,5
ABD 14	14
ABD 15	15
ABD 16	16
ABD 3/8"	17,2
ABD 18	18
ABD 19	19
ABD 20	20
ABD 1/2"	21,3
ABD 22	22
ABD 23	23
ABD 25	25
ABD 3/4"	26,9
ABD 28	28
ABD 30	30
ABD 32	32
ABD 1"	33,7
ABD 35	35
ABD 38	38
ABD 40	40
ABD 42.4	42,4

# MANÓMETROS



VERTICAL DIÁMETRO 63 mm.	
REFERENCIA	
MAN. 0 - 1 bar	
MAN. 0 - 2,5 bar	
MAN. 0 - 4 bar	
MAN. 0 - 6 bar	
MAN. 0 - 10 bar	
MAN. 0 - 12 bar	
MAN. 0 - 16 bar	
MAN. 0 - 20 bar	
MAN. 0 - 25 bar	
MAN. 0 - 40 bar	
MAN. 0 - 60 bar	
MAN. 0 - 100 bar	
MAN. 0 - 160 bar	
MAN. 0 - 250 bar	
MAN. 0 - 315 bar	
MAN. 0 - 400 bar	
MAN. 0 - 600 bar	

VERTICAL DIÁMETRO 100 mm.	
REFERENCIA	
MAN. 0 - 1 bar	
MAN. 0 - 2,5 bar	
MAN. 0 - 4 bar	
MAN. 0 - 6 bar	
MAN. 0 - 10 bar	
MAN. 0 - 12 bar	
MAN. 0 - 16 bar	
MAN. 0 - 20 bar	
MAN. 0 - 25 bar	
MAN. 0 - 40 bar	
MAN. 0 - 60 bar	
MAN. 0 - 100 bar	
MAN. 0 - 160 bar	
MAN. 0 - 250 bar	
MAN. 0 - 315 bar	
MAN. 0 - 400 bar	
MAN. 0 - 600 bar	



PANEL DIÁMETRO 63 mm.	
REFERENCIA	
MAN. 0 - 1 bar	
MAN. 0 - 2,5 bar	
MAN. 0 - 4 bar	
MAN. 0 - 6 bar	
MAN. 0 - 10 bar	
MAN. 0 - 12 bar	
MAN. 0 - 16 bar	
MAN. 0 - 20 bar	
MAN. 0 - 25 bar	
MAN. 0 - 40 bar	
MAN. 0 - 60 bar	
MAN. 0 - 100 bar	
MAN. 0 - 160 bar	
MAN. 0 - 250 bar	
MAN. 0 - 315 bar	
MAN. 0 - 400 bar	
MAN. 0 - 600 bar	

PANEL DIÁMETRO 100 mm.	
REFERENCIA	
MAN. 0 - 1 bar	
MAN. 0 - 2,5 bar	
MAN. 0 - 4 bar	
MAN. 0 - 6 bar	
MAN. 0 - 10 bar	
MAN. 0 - 12 bar	
MAN. 0 - 16 bar	
MAN. 0 - 20 bar	
MAN. 0 - 25 bar	
MAN. 0 - 40 bar	
MAN. 0 - 60 bar	
MAN. 0 - 100 bar	
MAN. 0 - 160 bar	
MAN. 0 - 250 bar	
MAN. 0 - 315 bar	
MAN. 0 - 400 bar	
MAN. 0 - 600 bar	

## RACORES DE CONTROL DE PRESIÓN



TOMAS MINIMEX BSP-MÉTRICAS-SAE-NPTF	
REFERENCIA	ROSCA
CSHR 1/8"	1/8" BSP
CSHR 1/4"	1/4" BSP
CSHR 3/8"	3/8" BSP
CSHR 8x1	8 x 1
CSHR 10x1	10 x 1
CSHR 10x1,25	10 x 1,25
CSHR 12x1,5	12 x 1,5
CSHR 14x1,5	14 x 1,5
CSHR 16x1,5	16 x 1,5
CSHR 7/16"	7/16" SAE -18
CSHR 1/2"	1/2" SAE - 20
CSHR 9/16"	9/16" SAE - 18
CSHR 1/8" NPT	1/8" NPT
CSHR 1/4" NPT	1/4" NPT



TOMAS MINIMEX ESPIGA LISA	
REFERENCIA	TUBO
CSHZ 6	6
CSHZ 8	8
CSHZ 10	10
CSHZ 12	12



TOMAS MINIMEX PARA MANÓMETRO	
REFERENCIA	ROSCA
CSHOR 1/4"	1/4"
CSHOR 1/2"	1/2"

## LATIGUILLOS MINIMEX - CAUDALÍMETROS



LATIGUILLOS MINIMEX	
REFERENCIA	ROSCA
CSHMS 500	16 x 2
CSHMS 1000	16 x 2
CSHMS 1500	16 x 2
CSHMS 2000	16 x 2
CSHMS 2500	16 x 2
CSHMS 3000	16 x 2
CSHMS 3500	16 x 2
CSHMS 4000	16 x 2
CSHMS 4500	16 x 2
CSHMS 5000	16 x 2



CAUDALÍMETROS	
REFERENCIA	CAUDAL (l./m.)
FT -5758- 02	60 l/min.
FT -5758- 03	120 l/min.
FT -6068 -01	200 l/min.
FT -6068- 03	400 l/min.

## CILINDROS DE SIMPLE EFECTO

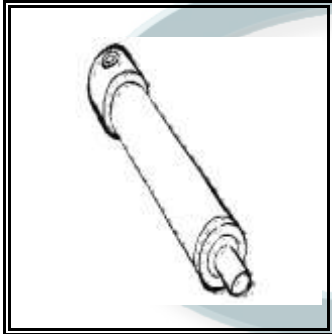

CILINDROS DE SIMPLE EFECTO		
REFERENCIA	VÁSTAGO	CARRERA
600 / 10	25	100
600 / 20	25	200
600 / 30	25	300
601 / 2	30	200
601 / 3	30	300
601 / 4	30	400
601 / 5	30	500
601 / 7	30	700
602 / 2	40	200
602 / 3	40	300
602 / 4	40	400
602 / 5	40	500
602 / 7	40	700
603 / 2	45	200
603 / 3	45	300
603 / 4	45	400
603 / 5	45	500
603 / 7	45	700
604 / 2	50	200
604 / 3	50	300
604 / 4	50	400
604 / 5	50	500
604 / 7	50	700
605 / 3	55	300
605 / 5	55	500
605 / 7	55	700
606 / 2	60	200
606 / 3	60	300
606 / 4	60	400
606 / 5	60	500
606 / 7	60	700



## CILINDROS DE DOBLE EFECTO

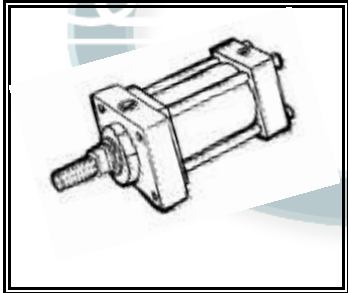

CILINDROS DE DOBLE EFECTO		
REFERENCIA	VÁSTAGO	PISTON
700 / 15	20	32
700 / 20	20	32
700 / 30	20	32
701 / 1	25	40
701 / 2	25	40
701 / 3	25	40
701 / 4	25	40
701 / 5	25	40
702 / 1	30	50
702 / 2	30	50
702 / 3	30	50
702 / 4	30	50
702 / 5	30	50
702 / 6	30	50
702 / 7	30	50
703 / 1	30	60
703 / 2	30	60
703 / 3	30	60
703 / 4	30	60
703 / 5	30	60
703 / 6	30	60
703 / 7	30	60
704 / 2	40	70
704 / 3	40	70
704 / 4	40	70
704 / 5	40	70
704 / 6	40	70
704 / 7	40	70
705 / 2	40	80
705 / 3	40	80
705 / 4	40	80
705 / 5	40	80
705 / 6	40	80
705 / 7	40	80
706 / 3	50	100
706 / 4	50	100
706 / 5	50	100
706 / 7	50	100
706 / 9	50	100

## VALVULERÍA



ESTRANGULADOR DE PIÑA BIDIRECCIONAL	
REFERENCIA	CAUDAL
FPMB 1/4"	12
FPMB 3/8"	30
FPMB 1/2"	45
FPMB 3/4"	85
FPMB 1"	100



ESTRANGULADOR DE PIÑA UNIIDIRECCIONAL	
REFERENCIA	CAUDAL
FPMU 1/4"	12
FPMU 3/8"	30
FPMU 1/2"	45
FPMU 3/4"	85
FPMU 1"	100



ANTIRRETORNO SIMPLE PILOTADO EN BLOQUE	
REFERENCIA	CAUDAL
FPD 1/4" 1R	12
FPD 3/8" 20 l. 1R	20
FPD 3/8" 1R	30
FPD 1/2" 1R	45
FPD 3/4" 1R	85



ANTIRRETORNO DOBLE PILOTADO EN BLOQUE	
REFERENCIA	CAUDAL
FPD 1/4"	12
FPD 3/8" 20 l.	20
FPD 3/8"	30
FPD 1/2"	45
FPD 3/4"	85



ANTIRRETORNO DOBLE PILOT. BLOQUE EN LINEA	
REFERENCIA	CAUDAL
FFDL 3/8"	30
FFDL 1/2"	45
FFDL 3/4"	65

## VALVULERÍA



### ANTIRRETORNO SIMPLE PILOT. BLOQUE LÍNEA

REFERENCIA	CAUDAL
FPSL 3/8"	30
FPSL 1/2"	45
FPSL 3/4"	85



### ANTIRRETORNO EN LÍNEA

REFERENCIA	CAUDAL
FPR 1/4"	12
FPR 3/8"	30
FPR 1/2"	45
FPR 3/4"	85
FPR 1"	140
FPR 1 1/4"	200
FPR 1 1/2"	310



### ANTIRRETORNO SIMPLE PILOTADO EN LÍNEA

REFERENCIA	CAUDAL
FPS 1/4"	12
FPS 3/8"	30
FPS 1/2"	45
FPS 3/4"	85



### ANTIRRETORNO INSERTABLE

REFERENCIA	CAUDAL
FPRI 1/4"	12
FPRI 3/8"	30
FPRI 1/2"	45
FPRI 3/4"	85



### CARTUCHO PARACAIDAS INSERTABLE

REFERENCIA	CAUDAL
FPP 1/4"	25
FPP 3/8"	50
FPP 1/2"	80
FPP 3/4"	150
FPP 1"	200

## VALVULERÍA



**VÁLVULA PARACAIDAS HEMBRA-HEMBRA**

REFERENCIA	CAUDAL
FFP 1/4"	25
FFP 3/8"	50
FFP 1/2"	80
FFP 3/4"	150
FFP 1"	200



**VÁLVULA PARACAIDAS MACHO-HEMBRA**

REFERENCIA	CAUDAL
MFP 1/4"	25
MFP 3/8"	50
MFP 1/2"	80
MFP 3/4"	150
MFP 1"	200



**REGULADOR DE CAUDAL BIDIRECCIONAL**

REFERENCIA	CAUDAL
FPB 1/42	12
FPB 3/8"	30
FPB 1/2"	45
FPB 3/4"	85



**REGULADOR DE CAUDAL UNIDIRECCIONAL**

REFERENCIA	CAUDAL
FPU 1/4"	12
FPU 3/8"	30
FPU 1/2"	45
FPU 3/4"	85



**VÁLVULA PROTECTORA DE MANÓMETRO**

REFERENCIA	CAUDAL
FPEA1G 1/4"	350
FPEA1G 1/4" 90°	350

## VALVULERÍA



LIMITADORA DE PRESIÓN EN LÍNEA	
REFERENCIA	CAUDAL
FPMD CB 40 P 3/8"	40
FPMD CB 40 P 1/2"	40
FPMD CB 70 P 1/2"	80
FPMD CB 70 P 3/4"	80



LIMITADORA DE PRESIÓN EN PANEL	
REFERENCIA	CAUDAL
FPMD CB 40 F 3/8"	40
FPMD CB 40 F 1/2"	40
FPMD CB 70 F 1/2"	80
FPMD CB 70 F 3/4"	80



OVERCENTER SIMPLE EFECTO	
REFERENCIA	CAUDAL
FPO S 1/4"	25
FPO S 3/8"	25
FPO S 1/2"	50



OVERCENTER DOBLE EFECTO	
REFERENCIA	CAUDAL
FPO D 3/8"	35
FPO D 1/2"	50



VÁLVULA DE SECUENCIA	
REFERENCIA	CAUDAL
VSQ 3/8"	40
VSQ 1/2"	40



SELECTORA DE CIRCUITO	
REFERENCIA	CAUDAL
FPT 1/4"	25
FPT 3/8"	50

## VALVULERÍA

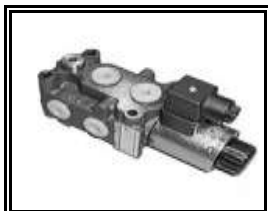

### ELECTROVÁLVULA SELECTORA

6 VÍAS - CETOP 03 - DN 6 -

VOLTAJE 12 - 24 - 48 DC

REFERENCIA	CAUDAL (l./m.)	PRESIÓN
KV 6/2 - 3/8"	50	210



### ELECTROVÁLVULA SELECTORA

6 VÍAS - CETOP 05 - DN 10 -

VOLTAJE 12 - 24 - 48 DC

REFERENCIA	CAUDAL (l./m.)	PRESIÓN
KV 6/2 - 1/2"	80	315



### ELECTROVÁLVULA SELECTORA

8 VÍAS - CETOP 03 - DN 6 -

VOLTAJE 12 - 24 - 48 DC

REFERENCIA	CAUDAL (l./m.)	PRESIÓN
KV 8/3 - 3/8"	50	210



### ELECTROVÁLVULA SELECTORA

APILABLE - DIN 6 -

VOLTAJE 12 - 24 - 48 DC

REFERENCIA	CAUDAL (l./m.)	PRESIÓN
KVH 6/2 - 3/8"	50	250



### EMPUÑADURA COBRA

#### REFERENCIA

EC 1 B - 1 BOTÓN

EC 2 B - 2 BOTONES

EC 3 B - 3 BOTONES

EC 4 B - 4 BOTONES

EC 1 I. - 1 INTERRUPTOR



### EMPUÑADURA CON BOTÓN

#### REFERENCIA

EE 1 B - 1 BOTÓN

EE 1 I. 1 INTERRUPTOR



### EMPUÑADURA ERGONÓMICA

#### REFERENCIA

EE 2 B - 2 BOTONES

EE 3 B - 2 BOTONES + INT.

EE 4 B - 4 BOTONES

EE 6 B - 4 BOTONES + INT

## PLACAS BASE MODULARES NG 6 - NG 10



PLACA BASE NG 6 SALIDA LATERAL - CETOP 03-	
REFERENCIA	MODULOS
PB 6 / 1 LATERAL	1
PB 6 / 2 LATERAL	2
PB 6 / 3 LATERAL	3
PB 6 / 4 LATERAL	4
PB 6 / 5 LATERAL	5
PB 6 / 6 LATERAL	6



PLACA BASE NG 6 CON VÁLVULA SEG. SALIDA LAT.	
REFERENCIA	MODULOS
PB 6 / 1 LATERAL + VALV.	1
PB 6 / 2 LATERAL + VALV.	2
PB 6 / 3 LATERAL + VALV.	3
PB 6 / 4 LATERAL + VALV.	4
PB 6 / 5 LATERAL + VALV.	5
PB 6 / 6 LATERAL + VALV.	6



PLACA BASE NG 10 SALIDA LATERAL - CETOP 05-	
REFERENCIA	MODULOS
PB 10 / 1 LATERAL	1
PB 10 / 2 LATERAL	2
PB 10 / 3 LATERAL	3
PB 10 / 4 LATERAL	4
PB 10 / 5 LATERAL	5
PB 10 / 6 LATERAL	6



PLACA BASE NG 10 CON VÁLVULA SEG. SALIDA LAT.	
REFERENCIA	MODULOS
PB 10 / 1 LATERAL + VALV.	1
PB 10 / 2 LATERAL + VALV.	2
PB 10 / 3 LATERAL + VALV.	3
PB 10 / 4 LATERAL + VALV.	4
PB 10 / 5 LATERAL + VALV.	5
PB 10 / 6 LATERAL + VALV.	6

## ACCESORIOS



DEPÓSITOS	
REFERENCIA	CAPACIDAD
DEP 12	12 l.
DEP 16	16 l.
DEP 30	30 l.
DEP 55	55 l.
DEP 75	75 l.
DEP 100	100 l.
DEP 150	180 l.



TAPÓN DE LLENADO	
REFERENCIA	MODELO
TR 1	NORMAL
TR 2	LARGO



NIVELES	
REFERENCIA	MODELO
LG 1	76 mm.
LG 1-T	76 mm. c/term.
LG 2	127 mm.
LG 2-T	127 mm. c/term.
LG 3	254 mm.
LG 3-T	24 mm. c/term.



VISORES	
REFERENCIA	CAPACIDAD
VISOR 04	1/4"
VISOR 06	3/8"
VISOR 08	1/2"
VISOR 12	3/4"
VISOR 16	1"
VISOR 20	1 1/4"
VISOR 24	1 1/2"
VISOR 32	2"



REGULADORES DE FLUJO	
REFERENCIA	CAUDAL (l./m.)
REG/FLUJO 1/2"-25	0-25
REG/FLUJO 1/2"-50	0-50
REG/FLUJO 3/4"-50	0-50
REG-FLUJO 3/4"-75	0-75



## ACCESORIOS



CAMPANAS		
REFERENCIA	GRUPO	MOTOR
LS 141	1	0,16-0,25
LS 161	1	0,33-0,5
LS 201	1	0,75-2
LS 250	1	3-5,5
LS 203	2	0,75-2
LS 252	2	3-5,5
LS 300	2	7,5-15
LS 255	3	3-5,5
LS 302	3	7,5-15



ACOPLAMIENTOS		
REFERENCIA	GRUPO	MOTOR
ND 3	1	0,16-0,25
ND 2	1	0,33-0,5
ND 5	1	0,75-1
ND 8	1	1,5-2
ND 11	1	3-5,5
ND 7	2	0,75-1
ND 10	2	1,5-2
ND 13	2	3-5,5
ND 16	2	7,5-15
ND 43 A	2	15-20
ND 15	3	3-5,5
ND 17	3	7,5-15
ND 43 C	3	15-20



FINAL DE CARRERA	
REFERENCIA	CAUDAL
FC 1/4"	25
FC 3/8"	50
FC 1/2"	70
FC 3/4"	100



FINAL DE CARRERA (VOLQUETES)	
REFERENCIA	CAUDAL
VFC 08 1/2"	50
VFC 12 3/4"	100

## FILTRACIÓN



FILTRO ASPIRACIÓN		
REFERENCIA	ROSCA	CAUDAL (l./m.)
STM 10-3/8"	3/8"	10
STM 15-1/2"	1/2"	15
STM 25-3/4"	3/4"	25
STM 50-1"	1"	50
STM 80-1 1/4"	1 1/4"	80
STM 95-1 1/2"	1 1/2"	95
STM 130-1 1/2"	1 1/2"	130
STM 180-2"	2"	180
STM 225-2"	2"	225



CARCASA	
REFERENCIA	ROSCA
FA 1 10/11	3/4"
FA 1 20/21	1 1/4"
FA 1 30/31	1 1/2"
FA 1 40/41	1 1/2"



CARTUCHO
REFERENCIA
SPA 1 10
SPA 1 11
SPA 1 20
SPA 1 21

## FILTRACIÓN



FILTRO DE RETORNO SEMI-SUMERGIDO	
REFERENCIA	ROSCA
FR 1 10	1/2"
FR 1 20	1/2"
FR 1 21	3/4"
FR 1 22	3/4"
FR 1 23	1"
FR 1 40	1"
FR 1 41	1 1/4"
FR 1 50	1 1/2"
FR 1 51	1 1/4"
FR 1 52	1 1/2"
FR 1 60	1 1/2"
FR 1 61	2"
FR 1 64	2"



CARTUCHO	
REFERENCIA	
R 1 10	
R 1 20	
R 1 22	
R 1 40	
R 1 50	
R 1 51	
R 1 60	
R 1 64	
R 1 65	

## PRESOSTATOS



NORMALMENTE ABIERTO		
REFERENCIA	REGULACION	PRESION MAX.
K4 S	1-12	300
K4 TP	5-50	300
K4 V	10-100	300
K4 Z	20-200	300



NORMALMENTE CERRADO		
REFERENCIA	REGULACION	PRESION MAX.
K4 S	1-12	300
K4 TP	5-50	300
K4 V	10-100	300
K4 Z	20-200	300



CONMUTABLE		
REFERENCIA	REGULACION	PRESION MAX.
F 31	1-12	25
F 33 P	5-50	300
F 35 P	10-100	300
F 37	30-250	250



REGULABLE DE PISTÓN		
REFERENCIA	REGULACION	PRESION MAX.
K 53 P	2,40	200
K 54 P	5-100	300
K 55 P	20-200	400
K 57 P	30-300	500
K 59 P	40-400	600

## BOMBAS MANUALES



BOMBA MANUAL SIMPLE EFECTO				
REFERENCIA	Ø T	PRESION	DEPOSITO	CM3
P 12 / SE 2,5	12	220	2,5 l.	7
P 12 / SE 4	12	220	4 l.	7
P 12 / SE 6	12	220	6 l.	7
P 16 / SE 2,5	16	180	2,5 l.	12
P 16 / SE 4	16	180	4 l.	12
P 16 / SE 6	16	180	6 l.	12
P 16 / SE 8	16	180	8 l.	12
P 20 / SE 4	20	140	4 l.	16
P 20 / SE 6	20	140	6 l.	16



BOMBA MANUAL DOBLE EFECTO				
REFERENCIA	Ø T	PRESION	DEPOSITO	CM3
P 16 / DE 2,5	16	180	2,5 l.	12
P 16 / DE 4	16	180	4 l.	12
P 16 / DE 6	16	180	6 l.	12
P 16 / DE 8	16	180	8 l.	12
P 20 / DE 4	20	140	4 l.	18
P 20 / DE 6	20	140	6 l.	18

## DISTRIBUIDORES MANUALES



DISTRIBUIDOR MD 3/8"		
REFERENCIA	BAR	CAUDAL (l/m.)
MD 1 PALANCA	250	45
MD 2 PALANCAS	250	45
MD 3 PALANCAS	250	45
MD 4 PALANCAS	250	45
MD 5 PALANCAS	250	45
MD 6 PALANCAS	250	40



DISTRIBUIDOR ML 3/8"		
REFERENCIA	BAR	CAUDAL (l/m.)
ML 1 PALANCA	300	40
ML 2 PALANCAS	300	40
ML 3 PALANCAS	300	40
ML 4 PALANCAS	300	35
ML 5 PALANCAS	300	35
ML 6 PALANCAS	300	35



DISTRIBUIDOR DN 1/2"		
REFERENCIA	BAR	CAUDAL (l/m.)
DN 1 PALANCA	350	50
DN 2 PALANCAS	350	50
DN 3 PALANCAS	350	50
DN 4 PALANCAS	350	50
DN 5 PALANCAS	350	50
DN 6 PALANCAS	350	50

# BOMBAS DE ENGRANAJES

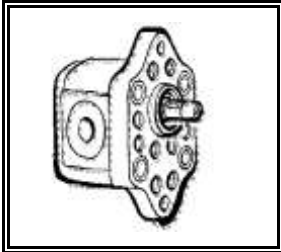

BOMBAS ENGRANAJES GRUPO 1	
REFERENCIA	CAUDAL (cm3)
SNP1 1,2	1,2
SNP1 1,7	1,7
SNP1 2,2	2,2
SNP1 2,6	2,6
SNP1 3,2	3,2
SNP1 3,8	3,8
SNP1 4,3	4,3
SNP1 6	6
SNP1 7,8	7,8

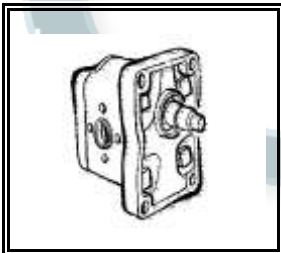

BOMBAS ENGRANAJES GRUPO 2	
REFERENCIA	CAUDAL (cm3)
SNP2 4	4
SNP2 6	6
SNP2 8	8
SNP2 11	11
SNP2 14	14
SNP2 17	17
SNP2 19	19
SNP2 22	22
SNP2 25	25

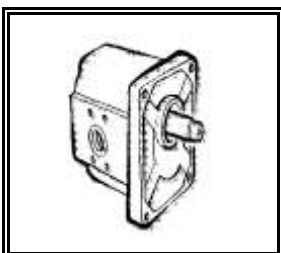

BOMBAS ENGRANAJES GRUPO 3	
REFERENCIA	CAUDAL (cm3)
SNP3 22	22
SNP3 26	26
SNP3 33	33
SNP3 38	38
SNP3 44	44
SNP3 48	48
SNP3 55	55
SNP3 63	63

## MOTORES ORBITALES

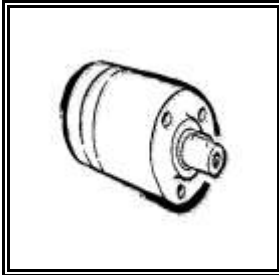

**OML - MOTOR CON EJE CILINDRICO DE 16 mm.**

REFERENCIA	CODIGO
OML 8	151G2001
OML 12,5	151G2002
OML 20	151G2003
OML 32	151G2004

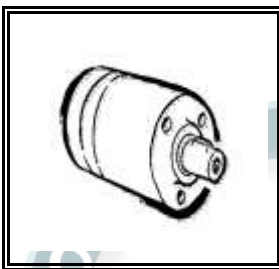

**OMM - MOTOR CON EJE CILINDRICO DE 16 mm.**

REFERENCIA	CODIGO
OMM 8 TRAS.	151G0040
OMM 12,5 TRAS.	151G0001
OMM 20 TRAS.	151G0002
OMM 32 TRAS.	151G0003
OMM 50 TRAS.	151G0037

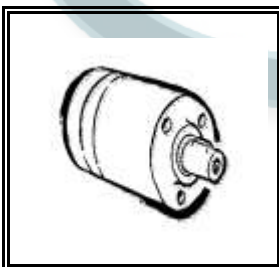

**OMM - MOTOR CON EJE CILINDRICO DE 16 mm.**

REFERENCIA	CODIGO
OMM 8 LAT.	151G0041
OMM 12,5 LAT.	151G0004
OMM 20 LAT.	151G0005
OMM 32 LAT.	151G0006
OMM 50 LAT.	151G0013

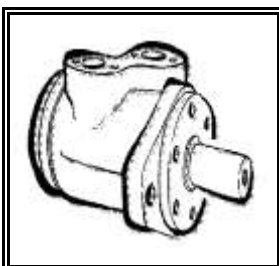

**OMP - MOTOR CON EJE CILINDRICO DE 25 mm.**

REFERENCIA	CODIGO
OMP 40	151-0642
OMP 50	151-0610
OMP 60	151-0611
OMP 100	151-0612
OMP 125	151-0613
OMP 150	151-0614
OMP 200	151-0615
OMP 250	151-0616
OMP 315	151-0617
OMP 400	151-0618



## MOTORES ORBITALES

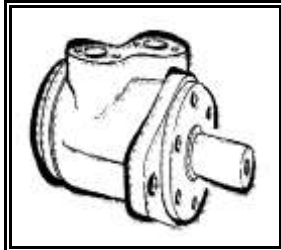

### OMP - MOTOR CON EJE CILÍNDRICO DE 25 mm.

REFERENCIA	CÓDIGO
OMR 50	151-0410
OMR 80	151-0411
OMR 100	151-0412
OMR 125	151-0413
OMR 160	151-0414
OMR 200	151-0214
OMR 250	151-0215
OMR 315	151-0216
OMR 375	151-0217

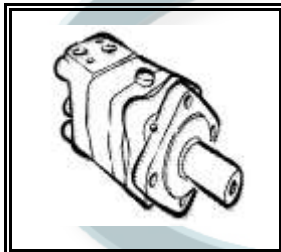

### OMS - MOTOR CON EJE CILÍNDRICO DE 32 mm.

REFERENCIA	CÓDIGO
OMS 80	151F0200
OMS 100	151F0201
OMS 125	151F0202
OMS 160	151F0203
OMS 200	151F0204
OMS 250	151F0205
OMS 315	151F0206
OMS 400	151F0305

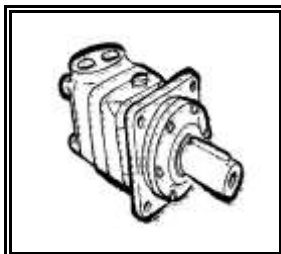

### OMT - MOTOR CON EJE CILÍNDRICO DE 40 mm

REFERENCIA	CÓDIGO
OMT 160	151B3000
OMT 200	151B3001
OMT 250	151B3002
OMT 315	151B3003
OMT 400	151B3004
OMT 500	151B3005

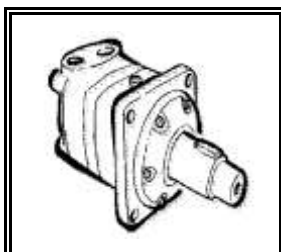

### OMV - MOTOR CON EJE CILÍNDRICO DE 40 mm.

REFERENCIA	CÓDIGO
OMV 315	151B3100
OMV 400	151B3101
OMV 500	151B3102
OMV 630	151B3103
OMV 800	151B3104

# DIRECCIONES HIDRÁULICAS

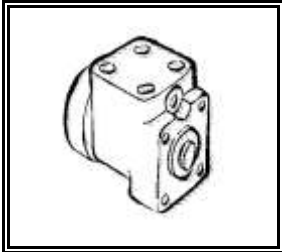

DIRECCIÓN HIDRÁULICA SIN VÁLVULAS	
REFERENCIA	CÓDIGO
OSP 50	150-0039
OSP 80	150-0040
OSP 100	150-0041
OSP 125	150-0042
OSP 160	150-0043
OSP 200	150-0044
OSP 315	150-0045
OSP 400	150-0046
OSP 500	150-0047
OSP 630	150-0048
OSP 800	150-0049
OSP 1000	150-0050

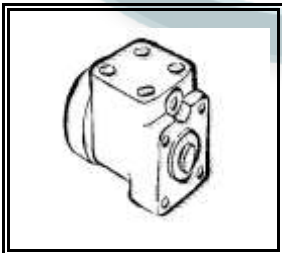

DIRECCIÓN HIDRÁULICA CON VÁLVULAS	
REFERENCIA	CÓDIGO
OSPC 50	150-1166
OSPC 80	150-1157
OSPC 100	150-1156
OSPC 125	150-1171
OSPC 160	150-1168
OSPC 200	150-1177
OSPC 315	150-1175

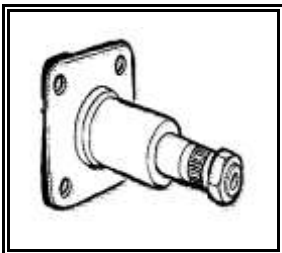

COLUMNA DE DIRECCIÓN	
REFERENCIA	CODIGO
OTPB 75	150-5031
OTPB 150	150-5032
OTPB 750	150-5033

## BOMBAS AUTO-ASPIRANTES



<b>BOMBA DE ENGRANAJES DE ALTA PRESIÓN</b>	
REFERENCIA	CAUDAL
BER 15	15
BER 22	22
BER 36	36
BER 43	43
BER 57	57
BER 65	65
BER 79	79
BER 84	84
BER 100	100
BER 115	115
BER 132	132



<b>BOMBA DE PISTONES ALTA PRESIÓN</b>	
REFERENCIA	CAUDAL
BPR 19	19
BPR 25	25
BPR 37	37
BPR 50	50
BPR 60	60
BPR 70	70
BPR 80	80
BPR 90	90
BPR 100	100



<b>BOMBA DE PISTONES ACODADA ALTA PRESIÓN</b>	
REFERENCIA	CAUDAL
BPC 18	18
BPC 25	25
BPC 35	35
BPC 40	40
BPC 50	50
BPC 65	65
BPC 80	80
BPC 110	110

## INTERCAMBIADORES



AIRE-ACEITE DE 10 A 80 l/min.	
REFERENCIA	VOLTAJE
AP 300 E	12 v.
AP 300 E	24 v.
AP 300 E	220 v.

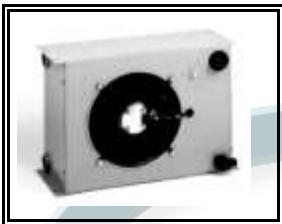

AIRE-ACEITE DE 20 A 150 l/min.	
REFERENCIA	VOLTAJE
AP 300 E / 2 E	12 v.
AP 300 E / 2 E	24 v.
AP 300 E / 2 E	220 v.



AIRE-ACEITE DE 30 A 150 l/min.	
REFERENCIA	VOLTAJE
AP 430	12 v.
AP 430	24 v.
AP 430	220 v.

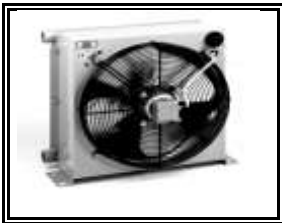

AIRE-ACEITE DE 30 A 180 l/min.	
REFERENCIA	VOLTAJE
AP 430 / 2	12 v.
AP 430 / 2	24 v.
AP 430 / 2	220 v.



AGUA-ACEITE	
REFERENCIA	CAUDAL (l/m.)
T60B1 - 1/4"	5 - 30
T80B1 - 3/4"	20 - 50
T80B3 - 3/4"	30 - 80

# ELECTROVÁLVULAS



<b>ELECTROVALVULA NG 6</b> 1 BOBINA 70 I./m. CETOP 03 VOLTAJE 12-24-110-220 v.	
REFERENCIA	ESQUEMA
4D01-3-111-0101	
4D01-3-101-0601	
4D01-3-103-0101	
4D01-3-107-0601	
4D01-3-101-0501	
4D01-3-107-0501	

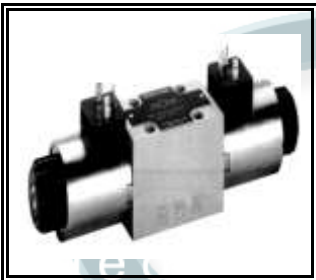

<b>ELECTROVALVULA NG 6</b> 2 BOBINAS 70 I./m. CETOP 03 VOLTAJE 12-24-110-220 v.	
REFERENCIA	ESQUEMA
4D01-3-201-0601	
4D01-3-203-0101	
4D01-3-207-0601	
4D01-3-208-0501	
4D01-3-210-0501	



<b>ELECTROVALVULA NG 10</b> 1 BOBINA 100 I./m. CETOP 05 VOLTAJE 12-24-110-220 v.	
REFERENCIA	ESQUEMA
4D02-3-111-0101	
4D02-3-101-0601	
4D02-3-103-0101	
4D02-3-107-0601	
4D02-3-101-0501	
4D02-3-107-0501	

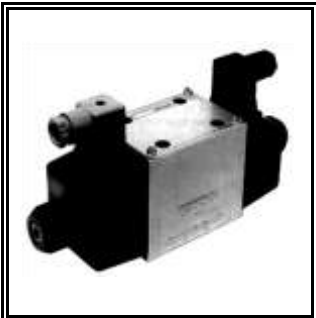

<b>ELECTROVALVULA NG 10</b> 2 BOBINAS 100 I./m. CETOP 05 VOLTAJE 12-24-110-220 v.	
REFERENCIA	ESQUEMA
4D02-3-201-0601	
4D02-3-203-0101	
4D02-3-207-0601	
4D02-3-208-0501	
4D02-34-216-0501	

## MAQUINAS DE PRENSAR



### MÁQUINAS DE PRENSAR ELÉCTRICAS

De tamaño medio, son ideales para el taller y fáciles de utilizar.

Permiten realizar el prensado de latiguillos de forma sencilla y rápida.

Para mangueras con refuerzo de 4 y 6 mallas desde 1/4" (módulo 04) hasta 2" (módulo 32).

tecnica.com

### MÁQUINAS DE PRENSAR MANUALES

Compactas y rápidas, ideales para el pequeño taller y el taller móvil.

Para mangueras con refuerzo de cuatro mallas desde 1/4" (módulo 04) hasta 1" (módulo 16) y mangueras con una y dos mallas de acero hasta 1 1/4" (módulo 20).



## GRUPOS HIDRÁULICOS Y MINICENTRALES



### CENTRALES HIDRÁULICAS

Fabricamos grupos hidráulicos conforme a las necesidades del cliente contando con un departamento técnico que previamente estudia cada caso.

### MINICENTRALES

Minicentrales hidráulicas de simple y doble efecto, estándar o conforme a sus necesidades.



## NEUMÁTICA



Racordaje, accesorios y racores automáticos disponibles en diversas configuraciones. Reguladores de caudal enchufes rápidos, silenciadores, etc:



Cilindros neumáticos y pinzas. Minicilindros ISO 6432, cilindros ISO 6431. cilindros sin vástago, unidades guía, etc.



Amplia gama de válvulas con accionamientos eléctricos y manuales.



Tubo neumático y espirales en diferentes materiales: poliuretano, rilsan y teflón.



Tratamiento del aire. Filtros, reguladores, filtros con lubricador, grupos de filtración



## ESTANQUIDAD



### EMPAQUETADURAS

Utilizadas generalmente en todo tipo de cilindros hidráulicos. Amplia gama de dimensiones normalizadas bajo norma ISO.



### COLLARINES

Fabricados en poliuretano y NBR para cilindros hidráulicos en vástago y pistón.



### RASCADORES

Con caja metálica y flexibles, fabricados en diferentes compuestos y disponibles hasta diámetro 1000 mm.



### JUNTAS PTFE

Compuestas por un anillo de PTFE y otro tórico. Mínima fricción y desgaste. Soportan altas presiones y temperaturas.



### GUÍAS

Evitan el rozamiento metálico entre las partes móviles de los cilindros. Fabricadas en distintos perfiles y dimensiones.



### RETENES

Anillos de retención para ejes rotativos. Uso generalizado en toda clase de fabricación de maquinaria.



### JUNTAS TORICAS

Juntas tóricas fabricadas en NBR, vitón, EPDM, silicona etc. Hilo tórico en diferentes diámetros. Aros de apoyo antiextrusión.

## VENTA Y REPARACION



VENTA Y REPARACIÓN de bombas y motores de pistones de caudal fijo y variable de las principales marcas del mercado SAUER DANFOSS, LINDE, KAWASAKI, COMMERCIAL, HYDROMATIK, POCLAIN, AXIAL PUMP, etc.  
Presupuesto de repación sin compromiso a coste cero.  
Venta de todo tipo de cilindros especiales. Reparación de cilindros normalizados.

## TUBERIA RIGIDA



### TUBO DE CONDUCCIÓN

Tubo de acero y acero bicromatado estirado en frío sin soldadura según DIN 2391. Diámetros desde 4 a 42 milímetros.



### TUBO LAPEADO

Tubo lapeado H8 y H9 en acero ST-52, según DIN 2593-2591. Diámetros desde 25 a 200



### BARRA CROMADA

Barra fabricada en acero F114 con recubrimiento de 20 a 25  $\mu$ . Diámetros desde 6 a 150 milímetros.

## FILTROS DE PRESIÓN



**FILTROS**  
Tipo Spin-On, de aspiración, semisumergidos, de retorno, en línea a baja, media y alta presión



**UNIDADES DE FILTRADO**  
Para descontaminación de los aceites hidráulicos o de lubricación. Muy útiles para el llenado y vaciado de depósitos.

